

RC Transfer systems catalogue:

page	Contents
P03	Common layout
P04	WT Workpiece Pallet
P08	TB Toothed belts
P10	BC Flat top chain/conveyor
P12	RT Accumulation roller chain
P16	CV Curves
P20	CU Curves
P22	HT Lift Transverse Units
P26	LF Lift Units
P30	HP Lift Positioning Units
P33	SP Stop gate
P36	Transfer line motor wiring diagram / parameter comparison table

Common layout

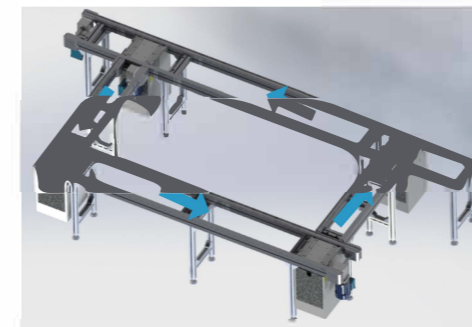

Horizontal loop layout

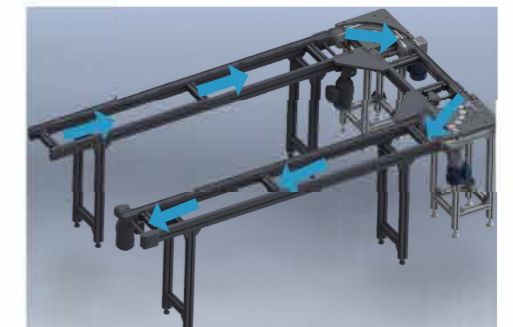

U-shaped layout



Vertical loop layout

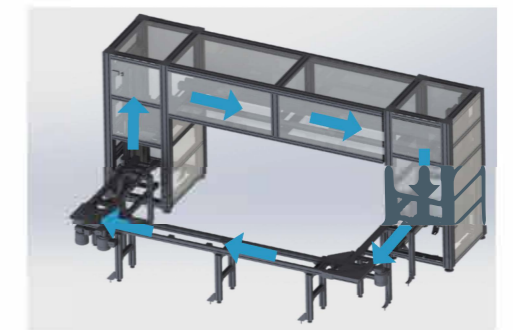

Open horizontal loop layout

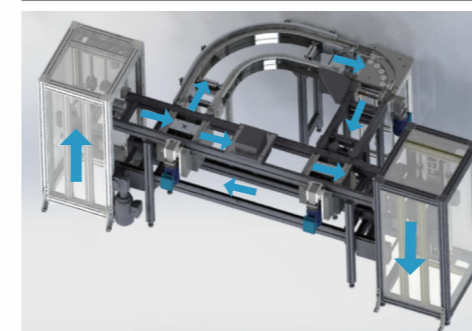

Horizontal and vertical loop layout

WT Workpiece Pallet

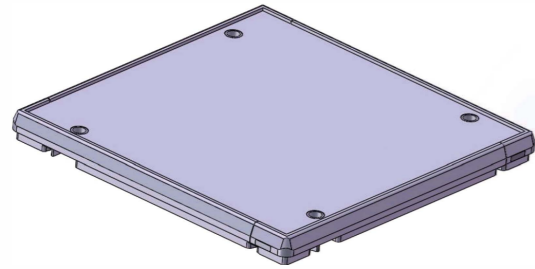

WT Workpiece Pallet

Feature

- 1 Suitable for flat top chain, toothed belt conveyor
- 2 Plastic frame module with aluminum/steel bearing plate
- 3 Steel bearing plate thickness: 5mm
- 4 Aluminum bearing plate thickness: 5mm/8mm/12mm
- 5 51 standard specifications
- 6 Integrated positioning pin sleeve, positioning accuracy can reach $\pm 0.1\text{mm}$
- 7 Integrated positioning lock pit, positioning accuracy can reach $\pm 0.5\text{mm}$
- 8 Metal induction gaskets are integrated at the bottom and side of the standard frame
- 9 Anti-static

Scope of supply

Bearing plate!) /Plastic frame module/Locating pin sets/Spring pin

Supply mode

Complete set (assembled) / Parts supply (please contact us)

- 1)Need to add workpiece or tooling installation hole, support to figure processing
- 2)Size: BXL=320X400mm, The bearing plate shall have 2 additional spring pin holes for auxiliary fastening , BXL=400x 400mm,The bearing plate shall have 2 additional spring pin holes for auxiliary fastening(B、 L refers to the working width and length of the pallet, Not the width and length of the pallet)

Order number description

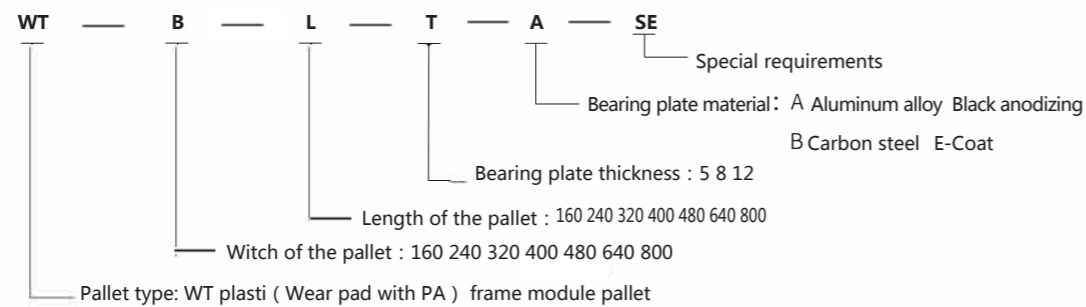

Sample order

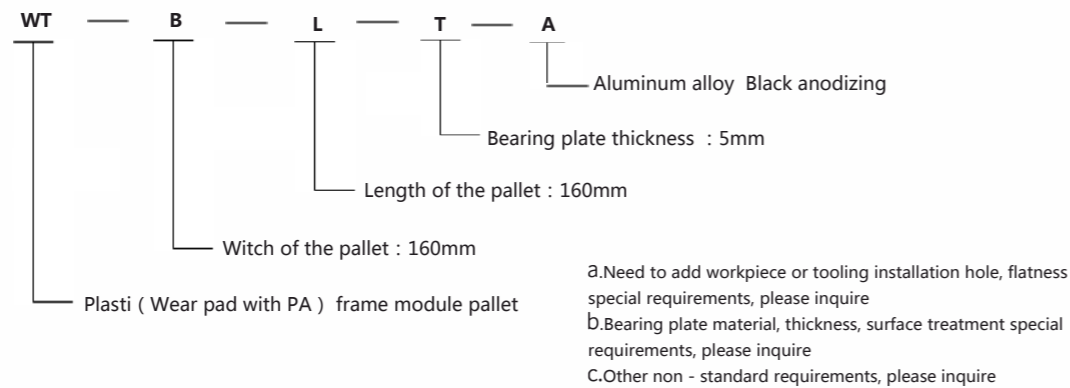

WT Workpiece Pallet

size 1)

Don't provide processing drawings

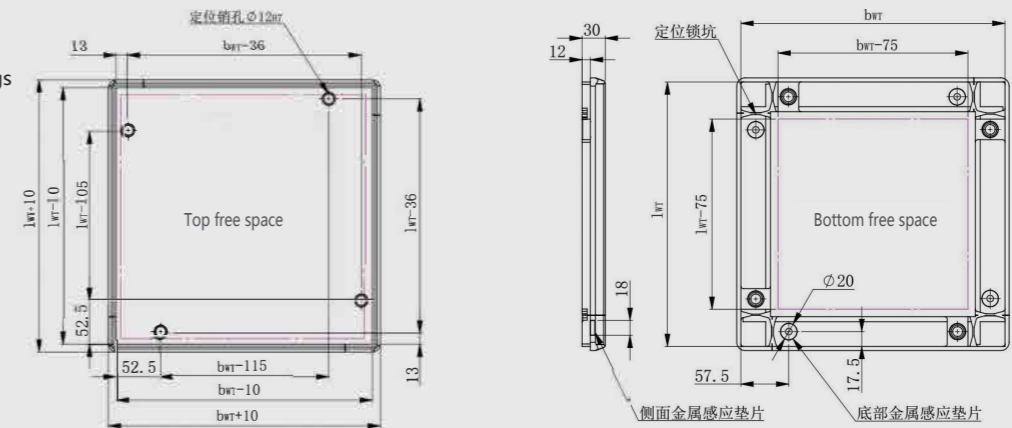

Package order number

ba(m)Xl(mm)	Bearing plate thickness	Bearing plate material	Flatness T(mm)	Surface treatment of bearing plate	Pallet weight 1mp(kg)
160×160	5	Aluminum alloy	0.3	Black anodizing	0.9
160×160	5	Carbon steel	0.3	Black electrophoresis	1.5
160×240	5	Aluminum alloy	0.3	Black anodizing	1.2
160×240	5	Carbon steel	0.3	Black electrophoresis	2.1
160×320	5	Aluminum alloy	0.3	Black anodizing	1.5
160×320	5	Carbon steel	0.3	Black electrophoresis	2.8
240×240	5	Aluminum alloy	0.3	Black anodizing	1.5
240×240	5	Carbon steel	0.3	Black electrophoresis	2.9
240×320	5	Aluminum alloy	0.5	Black anodizing	1.9
240×320	5	Carbon steel	0.5	Black electrophoresis	3.9
240×400	5	Aluminum alloy	0.5	Black anodizing	2.3
240×400	5	Carbon steel	0.5	Black electrophoresis	4.7
320×320	5	Aluminum alloy	0.5	Black anodizing	2.5
320×320	5	Carbon steel	0.5	Black electrophoresis	5.1
320×400	5	Aluminum alloy	0.5	Black anodizing	2.9
320×400	5	Carbon steel	0.5	Black electrophoresis	6.2
320×480	5	Aluminum alloy	0.6	Black anodizing	3.5
320×480	5	Carbon steel	0.6	Black electrophoresis	7.4
400×400	5	Aluminum alloy	0.6	Black anodizing	3.4
400×400	5	Carbon steel	0.6	Black electrophoresis	7.5
400×480	5	Aluminum alloy	0.6	Black anodizing	4.1
400×480	5	Carbon steel	0.6	Black electrophoresis	9
400×640	5	Carbon steel	0.8	Black electrophoresis	11.8
480×480	5	Aluminum alloy	0.8	Black anodizing	4.8
480×640	5	Carbon steel	0.8	Black electrophoresis	10.7
480×800	5	Carbon steel	1	Black electrophoresis	13.9
640×640	5	Carbon steel	1	Black electrophoresis	18.1
240×320	8	Aluminum alloy	0.5	Black anodizing	2.6
240×400	8	Aluminum alloy	0.5	Black anodizing	3.1
320×320	8	Aluminum alloy	0.5	Black anodizing	3.3
320×400	8	Aluminum alloy	0.5	Black anodizing	3.9
320×480	8	Aluminum alloy	0.6	Black anodizing	4.6
400×400	8	Aluminum alloy	0.6	Black anodizing	4.7
400×480	8	Aluminum alloy	0.6	Black anodizing	5.6
400×640	8	Aluminum alloy	0.8	Black anodizing	6.8
480×480	8	Aluminum alloy	0.8	Black anodizing	6.6
480×640	8	Aluminum alloy	0.8	Black anodizing	8.1
480×800	8	Aluminum alloy	1	Black anodizing	10
640×640	8	Aluminum alloy	0.8	Black anodizing	9.7
640×800	8	Aluminum alloy	1	Black anodizing	12.1
800×800	8	Aluminum alloy	1	Black anodizing	14.9
320×480	12	Aluminum alloy	0.5	Black anodizing	5.5
400×400	12	Aluminum alloy	0.5	Black anodizing	6.4
400×480	12	Aluminum alloy	0.6	Black anodizing	7.5
400×640	12	Aluminum alloy	0.8	Black anodizing	9.1
480×480	12	Aluminum alloy	0.6	Black anodizing	9
480×640	12	Aluminum alloy	0.8	Black anodizing	10.7
480×800	12	Aluminum alloy	0.8	Black anodizing	13.4
640×640	12	Aluminum alloy	1	Black anodizing	14.6
640×800	12	Aluminum alloy	1	Black anodizing	18.1
800×800	12	Aluminum alloy	1	Black anodizing	22.2

RC Pallet transfer systems

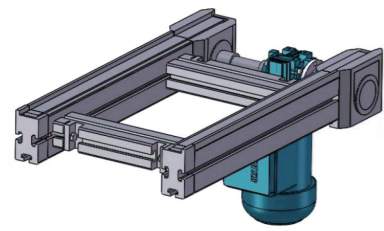

TB Toothed belts (end drive)

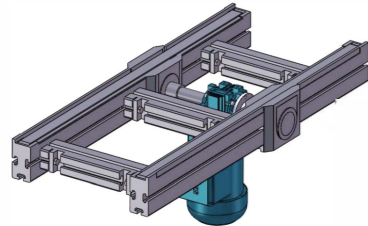

TB/M Toothed belts (center drive)

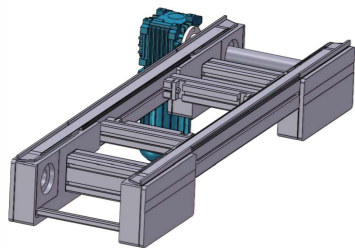

BC Flat top chain

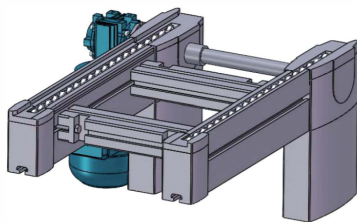

RT Accumulation roller chain

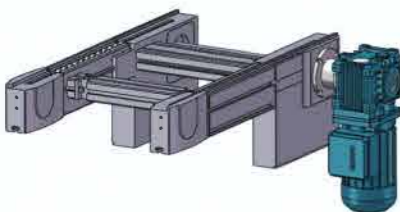

RT/H Accumulation roller chain

Application

Highly modular design, easy installation and maintenance ;
Three kinds of conveying medium (toothed belt, flat belt, accumulation roller chain); Single workpiece tray weight can be achieved 0-120kg;
It can be stacked, equipped with elbow unit, rotary table unit, jacking unit and hoist unit, which can easily realize various types of production line layout ;
Widely used in automotive parts, electronic appliances, motor and other industries.

Type

Tooth belt conveyor , conveyor section can carry 1kg/cm;
TB Toothed belts (end drive)
TB/M Toothed belts (center drive)

Flat top chain, conveyor section can carry 1kg/cm;
BC Flat top chain

Accumulation roller chain , conveyor section can carry 1.5kg/cm.
RT Accumulation roller chain
RT/H Accumulation roller chain

Considerations for model selection:

Tooth belt conveyor line, flat belt conveyor line is suitable for light load dry clean environment, roller chain is suitable for heavy load harsh environment 1);
With the use of non-square pallet, horizontal and vertical wheel feed line allows the maximum load of a single pallet may be different, the short side of the maximum load of a single pallet plays a decisive role ;
During the design, it is necessary to ensure that the total weight of the stacking workpiece tray is equal to the maximum allowable load of the small 1000 conveying section.

1)Suggested call for advice ;

TB Toothed belts

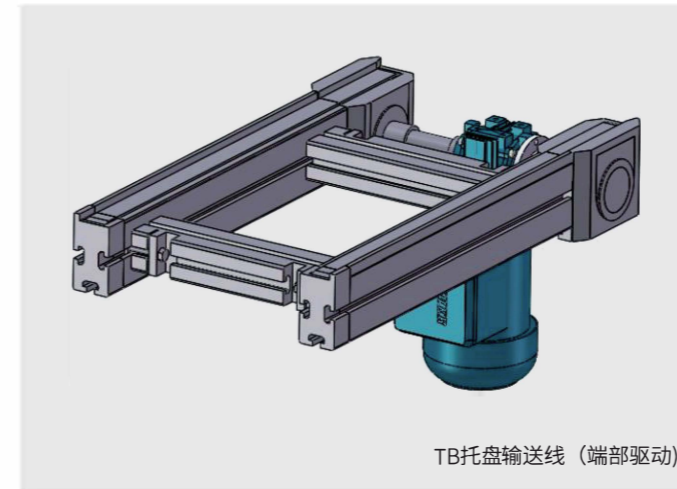

TB托盘输送线 (端部驱动)

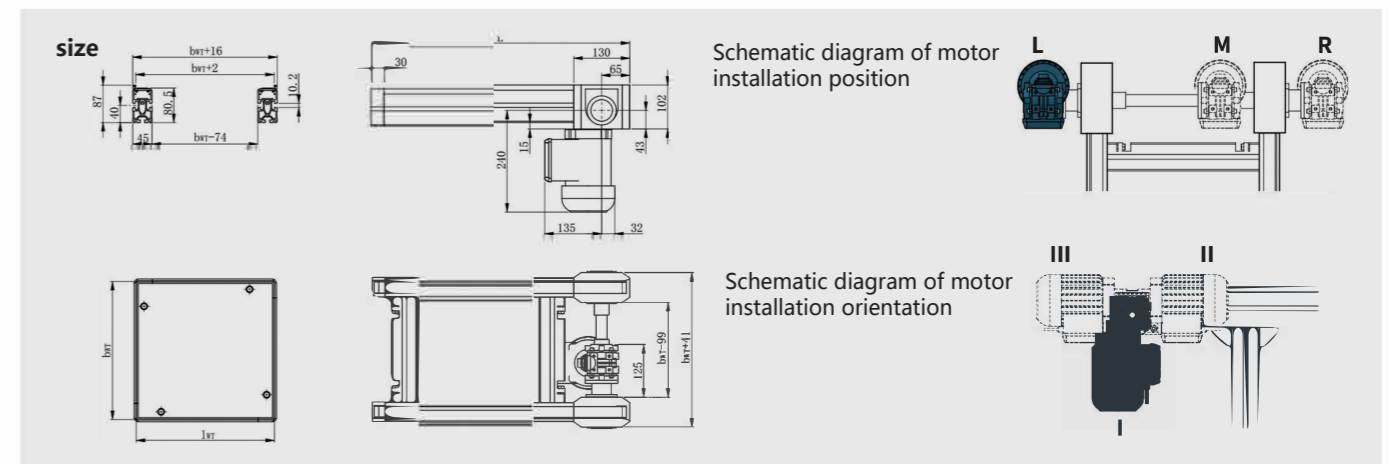

Parameter configuration

Conveying medium	TS Toothed belt (black, anti-static)
Accumulation conveyor allows maximum load	60KG
Full load rated speed VN	0,6,9,12,15,18 ¹⁾ (m/min)
Width of the pallet B	160,240,320,400,480,640,800 (mm)
	160 - 800 ²⁾
Line length L	300 - 6000 (mm)
Drive way	Direct drive
Voltage	220/380AC ³⁾
Frequency	50HZ ⁴⁾
Motor mounting position	R,L,M ⁵⁾
Motor power connection mode	Junction box ⁶⁾
Motor mounting bearing	I , II , III ⁷⁾

Feature

①Independent three-phase motor drive ¹⁾ ; ②It can be stacked and transported in reverse ; ③Highly modular design.

Scope of supply

Drive unit / Driven unit / Conveying section profile /TS tooth belt / Friction plate / Transverse joint section

Recommended spare parts

Holder / Connecting suite ²⁾ /Foot connecting suite

Supply mode

Complete set (assembled) / Parts supply (please contact us)

1)Other types of deceleration motor can be selected, please contact us ;
2)Fastening connection parts between conveying segments.

① Total load of single pallet ≤ 15kg.
② It is recommended to transport the tray in the opposite direction, if the reverse transport, the transport capacity will be reduced 1/3.
③ When the intermediate drive is selected, the drive unit shall be arranged close to the head end, and within 1/3 of the length of the whole line body.

TB Toothed belts

K9 Kf f k₂ \ [' \ d j

TB Toothed belts

TB Toothed belts

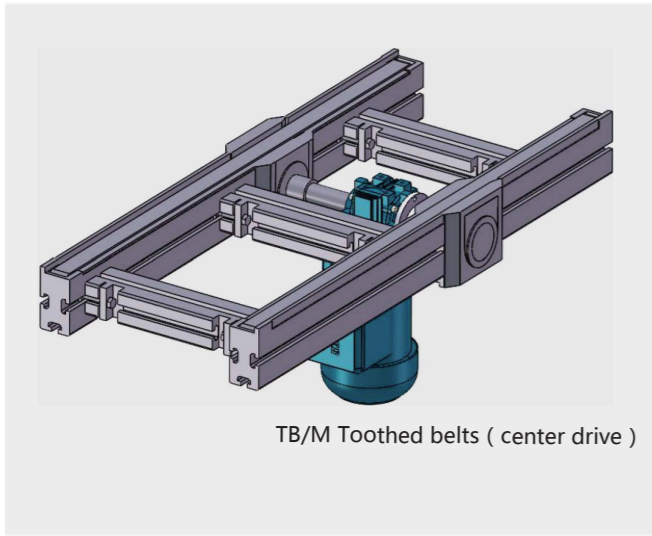

TB/M Toothed belts (center drive)

Feature

- 1) Independent three-phase motor drive ;
- 2) Can be stacked, allowing reverse transport;
- 3) Highly modular design;
- 4) Low noise.

Scope of supply

Drive unit / Driven unit / Conveying section profile /TS tooth belt / Friction plate / Transverse joint section

Recommended spare parts

Holder / Connecting suite2) /Foot connecting suite

Supply mode

Complete set (assembled) / Parts supply (please contact us)

- 1) Other types of deceleration motor can be selected, please contact us ;
- 2) Fastening connection parts between conveying segments.

Parameter configuration

Conveying medium	TS Toothed belt (black, anti-static)
Accumulation conveyor allows maximum load	60KG
Full load rated speed VN	0,6,9,12,15,18 ¹⁾ (m/min)
Width of the pallet B	160,240,320,400,480,640,800 (mm)
	160 - 800 ²⁾ (mm)
Line length L	300 - 6000 (mm)
Drive way	Direct drive
Voltage	220/380AC ³⁾
Frequency	50HZ ⁴⁾
Motor mounting position	R,L,M ⁵⁾
Motor power connection mode	Junction box ⁶⁾
Motor mounting bearing	I, II, III ⁷⁾

1)a.Full load rated speed is not recommended to exceed 20m/min; b.VN=0 , No reduction motor ; c.Other full load rated speed requirements are available.

2)Can be customized for other width types up to the maximum width1200mm;

3)Other power supply voltage requirements, please inquire ;

4)Other frequency requirements, please call advisory ;

5)Machine body in the middle of the installation only suitable for onlineoccasions B ≥240 occasions ;

6)a.The default position of junction box and outgoing line is shown in the circle. For other requirements, please contact us ; b.Other motor power connection requirements please contact us.

7)Other motor installation location requirements please contact us.

1) Total load of single pallet≤15kg.

1) It is recommended to transport the tray in the opposite direction, if the reverse transport, the transport capacity will be reduced1/3.

1) When the intermediate drive is selected, the drive unit shall be arranged close to the head end, and within 1/3 of the length of the whole line body.

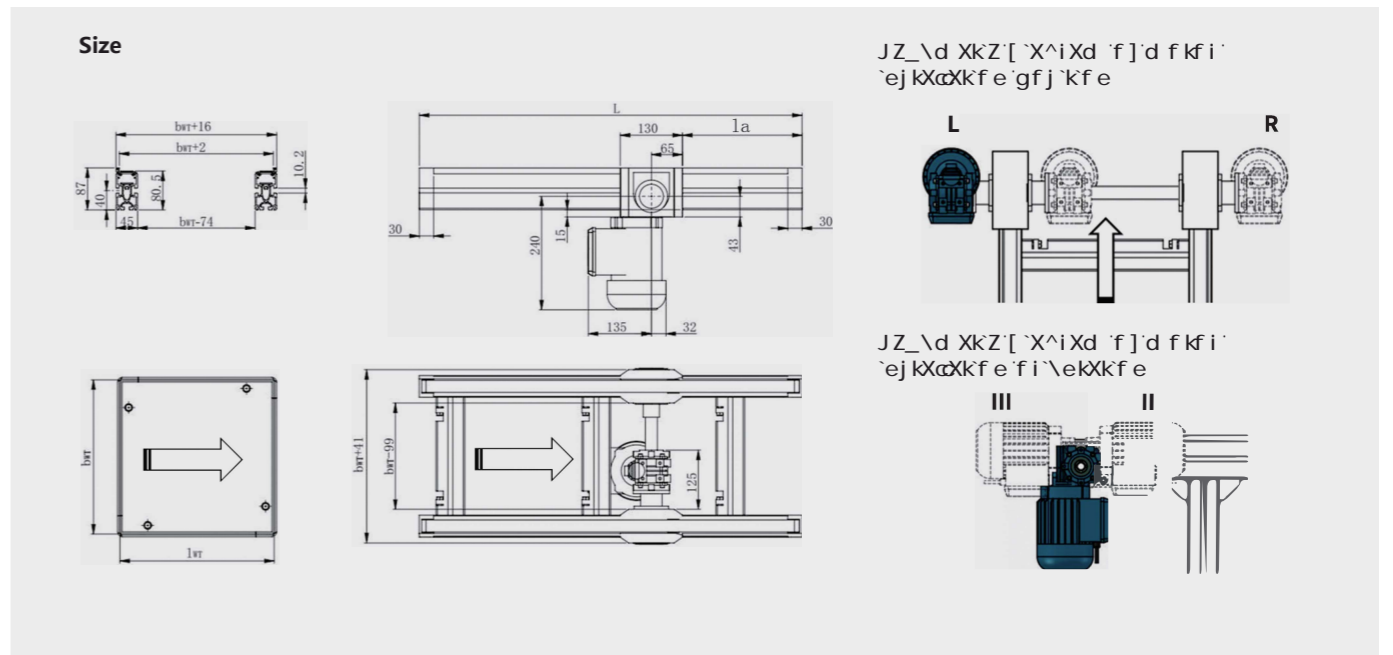

F i [\ i e l d Y i [\ j Z i g k f e

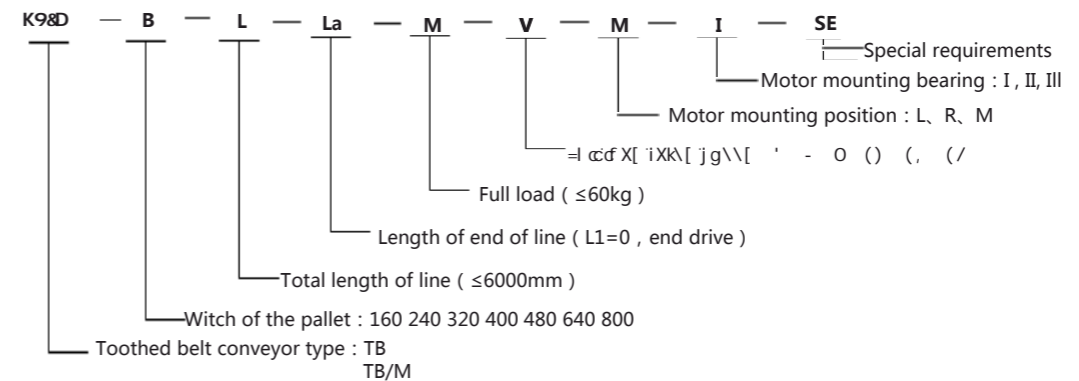

J X d g d f i [\ i

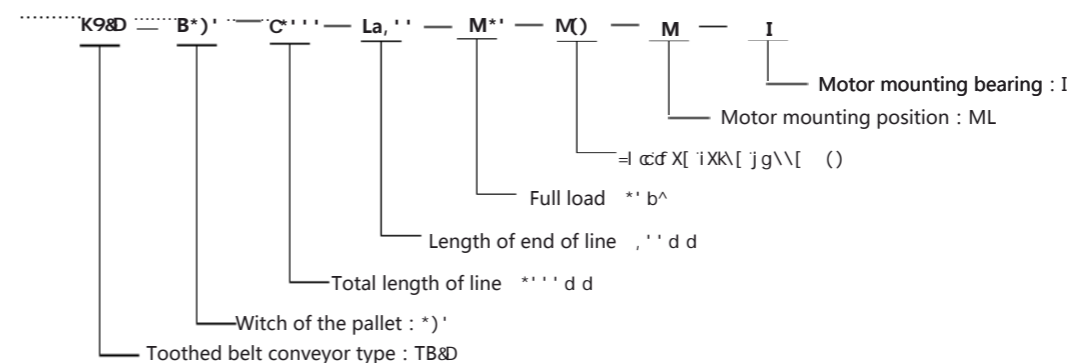

BC Flat top chain

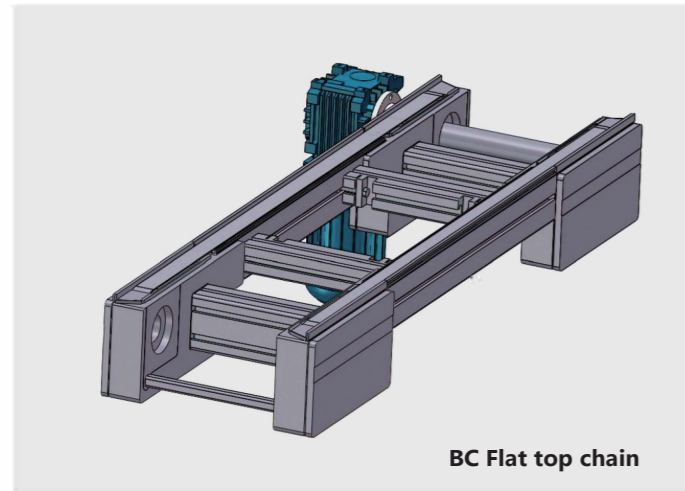

Feature

①Independent three-phase motor drive; ②Can be stacked, do not allow reverse transport; ③Highly modular design; ④ Low noise.

Scope of supply

Drive unit / Driven unit / Conveying section profile / Flat top belt / Friction plate / Intermediate connection kit ¹⁾/Transverse joint section

Recommended spare parts

Holder / Connecting suite ²⁾/Foot connecting suite

Supply mode

Complete set (assembled) / Parts supply (please contact us)

- 1)Fastening connection parts between sections of conveying section ;
- 2)Fastening connection parts between conveying segments.

Parameter configuration

Conveying medium	Flat top belt
Accumulation conveyor allows maximum load	250KG
Full load rated speed VN	0,6,9,12,15,18 ¹⁾ (m/min)
Width of the pallet B	160,240,320,400,480,640,800 (mm)
	160 - 800 ²⁾ (mm)
Line length L	1000 - 30000 (mm)
Drive way	Direct drive
Voltage	220/380AC ³⁾
Frequency	50HZ ⁴⁾
Motor mounting position	R,L
Motor power connection mode	Junction box ⁵⁾
Motor mounting bearing	I, II, III ⁶⁾

1)a.Full load rated speed is not recommended to exceed 20m/min; b.VN=0 , No reduction motor ; c.Other full load rated speed requirements are available.

2)Can be customized for other width types up to the maximum width1200mm;

3)Other power supply voltage requirements, please inquire;

4)Other frequency requirements, please inquire ;

5)a.The default position of junction box and outgoing line is shown in the circle. For other requirements, please contact us ; b.Other motor power connection requirements please contact us.

6)Other motor installation location requirements please contact us.

BC Flat top chain

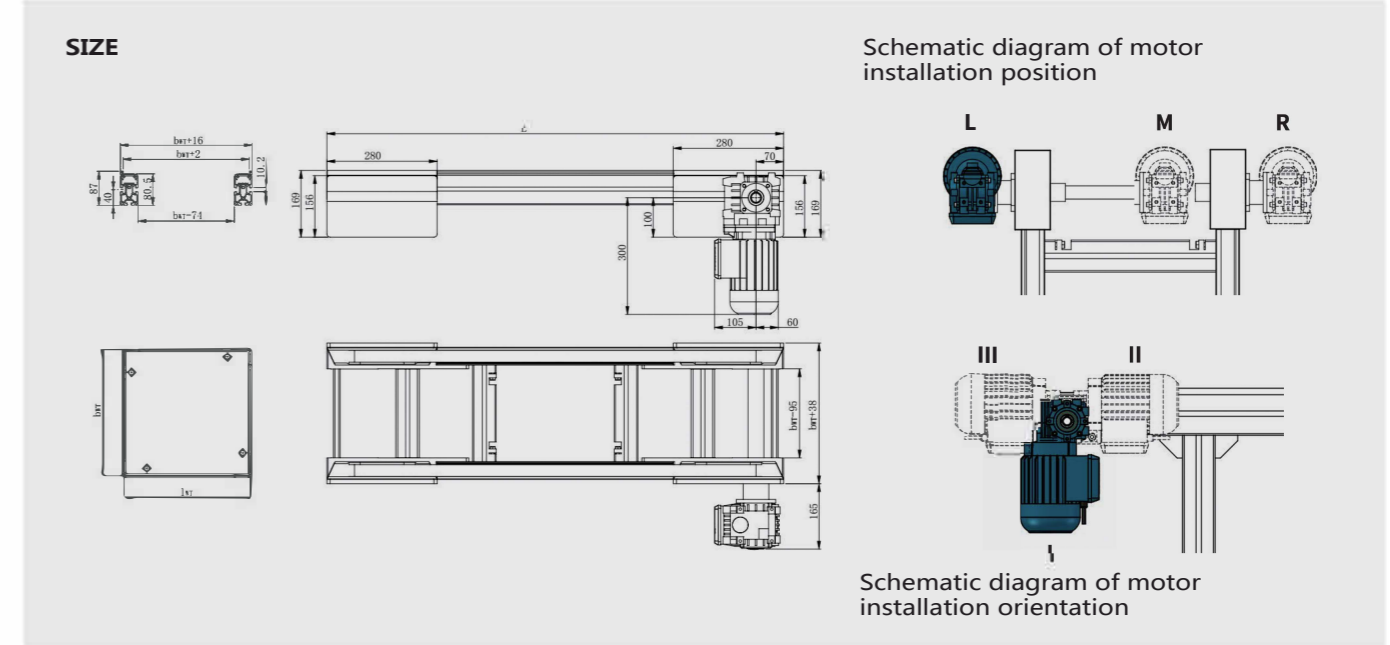

Order number description

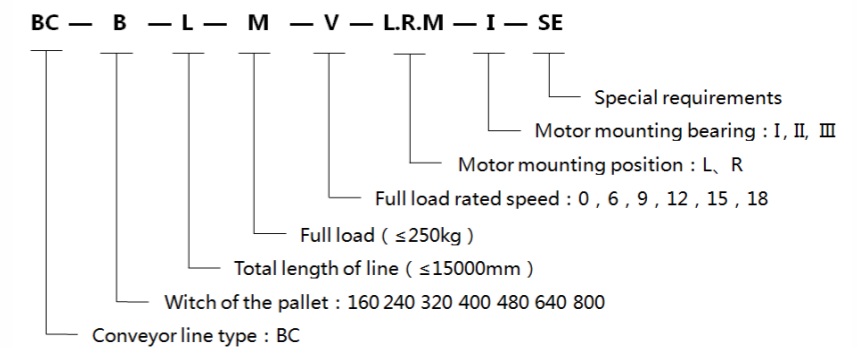

Sample order

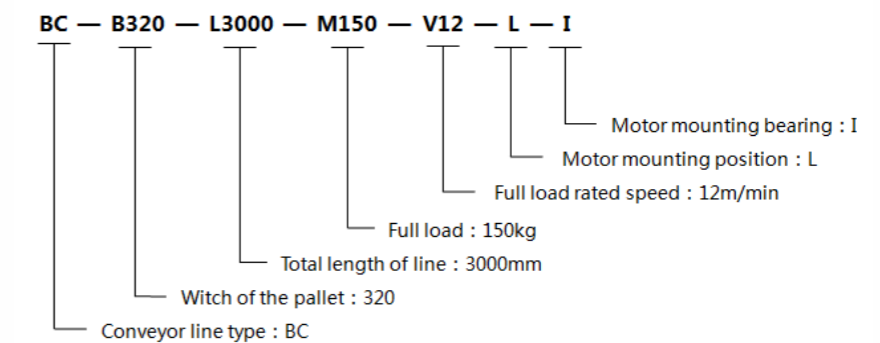

RT Accumulation roller chain

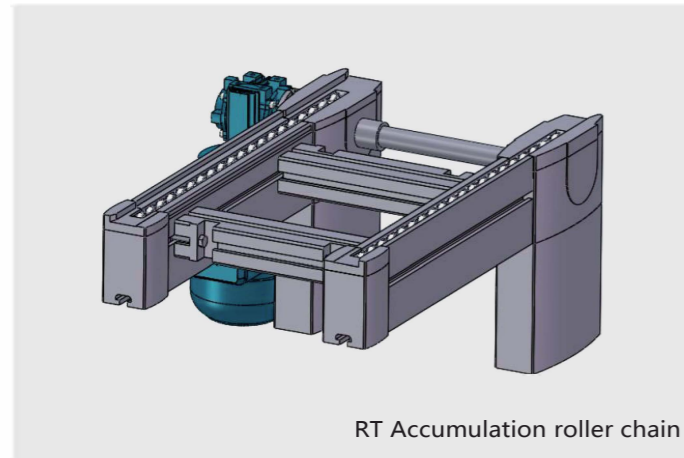

Feature

- ① Independent three-phase motor drive;
- ② Can be stacked ;
- ③ When length $L \leq 1800\text{mm}$ and there is no protective cover plate for small parts, reverse transmission is allowed ;
- ④ Highly modular design ;

Scope of supply

Drive unit / Driven unit / Conveying section profile / Flat top belt / Article friction pad / Transverse joint section

Recommended spare parts

Holder / Connecting suite 1) / Foot connecting suite

Supply mode

Complete set (assembled) / Parts supply (please contact us)

1) Fastening connection parts between conveying segments.

Parameter configuration

Conveying medium 1)	Steel roller chain Stacked steel roller chain with small protective cover plate
Accumulation conveyor allows maximum load	600kg
Full load rated speed VN	0,6,9,12,15,18 2) (m/min)
Width of the pallet B	160,240,320,400,480,640,800
	160至800 3) (mm)
Line length L	300至6000 4) (mm)
Drive way	Direct drive
Voltage	220/380AC 5)
Frequency	50HZ 6)
Motor mounting position	R,L
Motor power connection mode	Junction box 7)
Motor mounting bearing	I, II, III 8)

1) Single speed roller chain, pitch:12.7mm;

2) a. Full load rated speed is not recommended to exceed 20m/min;
b. $VN=0$, No reduction motor ; c. Other full load rated speed requirements are available;

3) Can be customized for other width types up to the , maximum width 1200mm;

4) When the transport line length of RT roller chain exceeds 6000mm, the driving tail structure is the same as RT/H;

5) Other power supply voltage requirements, please inquire;

6) Other frequency requirements, please inquire ;

7) a. The default position of junction box and outgoing line is shown in the circle. For other requirements, please contact us ; b. Other motor power connection requirements please contact us;

8) Other motor installation location requirements please contact us.

RT Accumulation roller chain

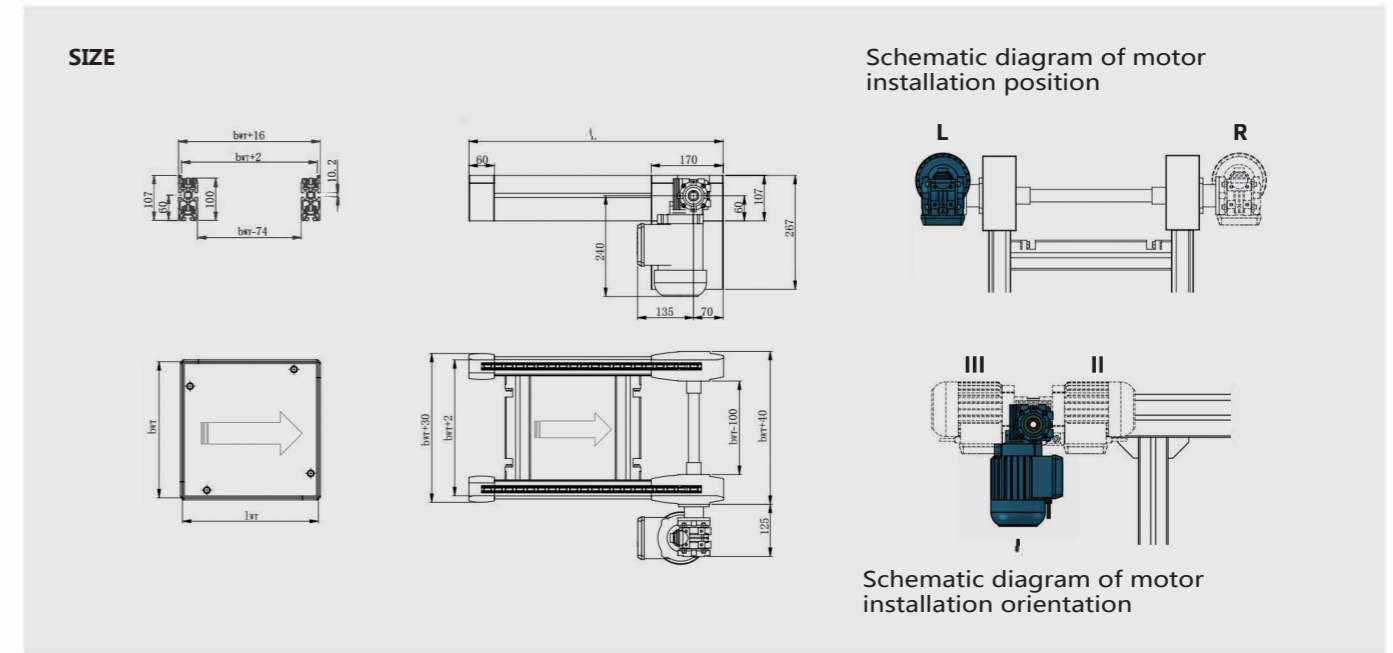

Order number description

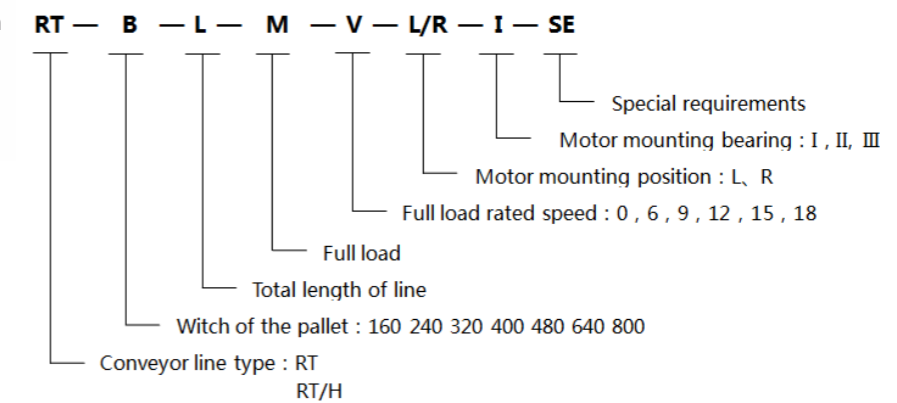

Sample order

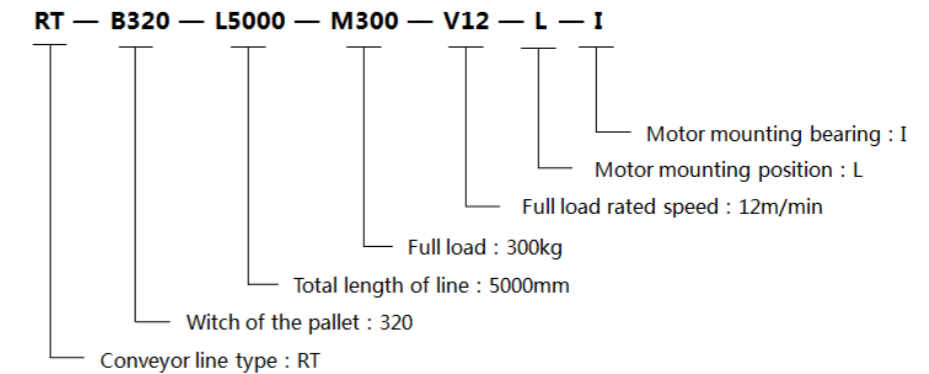

RT Accumulation roller chain

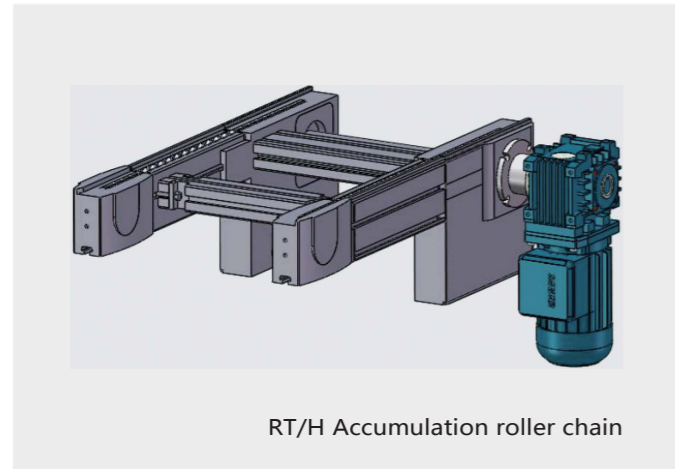

Feature

- ① Independent three-phase motor drive;
- ② Can be stacked ;
- ③ Non-reverse transport ;
- ④ Highly modular design ;

Scope of supply

Drive unit / Driven unit / Conveying section profile / Flat top belt / Article friction pad / Transverse joint section

Recommended spare parts

Holder / Connecting suite ¹⁾ /Foot connecting suite

Supply mode

Complete set (assembled) / Parts supply (please contact us)

1)Fastening connection parts between conveying segments.

Parameter configuration

Conveying medium ¹⁾	Steel roller chain Stacked steel roller chain with small protective cover plate
Accumulation conveyor allows maximum load	2000kg ²⁾
Full load rated speed VN	0,6,9,12,15,18 ³⁾ (m/min)
Width of the pallet B	160,240,320,400,480,640,800 160至800 ⁴⁾ (mm)
Line length L	1000至22000 ⁵⁾ (mm)
Drive way	Direct drive
Voltage	220/380AC ⁶⁾
Frequency	50HZ ⁷⁾
Motor mounting position	R,L
Motor power connection mode	Junction box ⁸⁾
Motor mounting bearing	I , II, III ⁹⁾

1)Single speed roller chain, pitch:12.7mm;

2) The conveying medium is nylon stacking roller chain. It is suggested that the full load of stacking should not exceed 1200kg;

3)a. Full load rated speed is not recommended to exceed 20m/min; b. VN=0 , No reduction motor ; c. VN≥18, suggest full load is less than 1500 kg; d. Other full load rated speed requirements are available;

4)Can be customized for other width types up to the , maximum width 1200mm;

5)The transmission medium is nylon stacking roller chain. It is suggested that the track length should not exceed 12m;

6)Other power supply voltage requirements, please inquire;

7)Other frequency requirements, please inquire ;

8) a. The default position of junction box and outgoing line is shown in the circle. For other requirements, please contact us ; b. Other motor power connection requirements please contact us;

9)Other motor installation location requirements please contact us.

RT Accumulation roller chain

SIZE

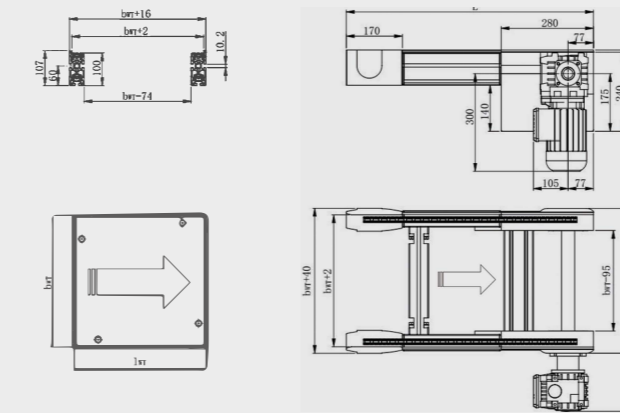

Schematic diagram of motor installation position

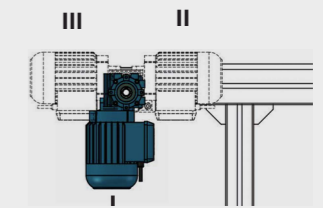
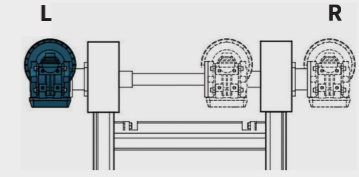

Schematic diagram of motor installation orientation

Order number description

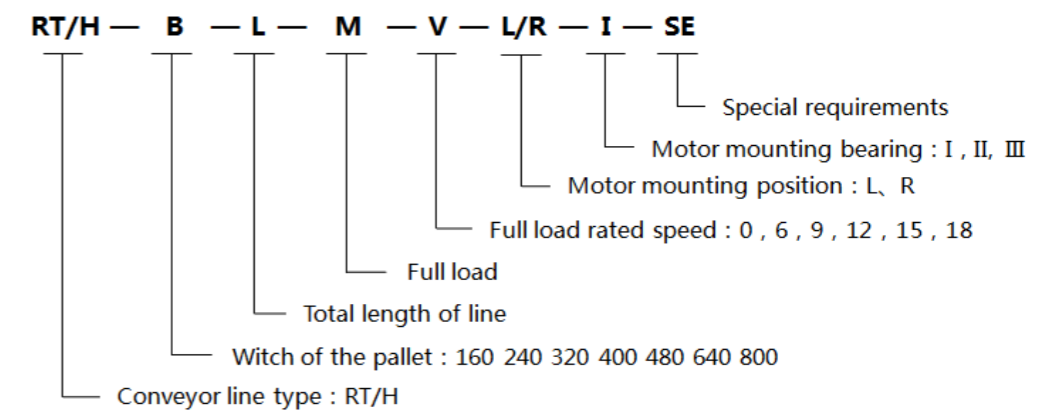

Sample order

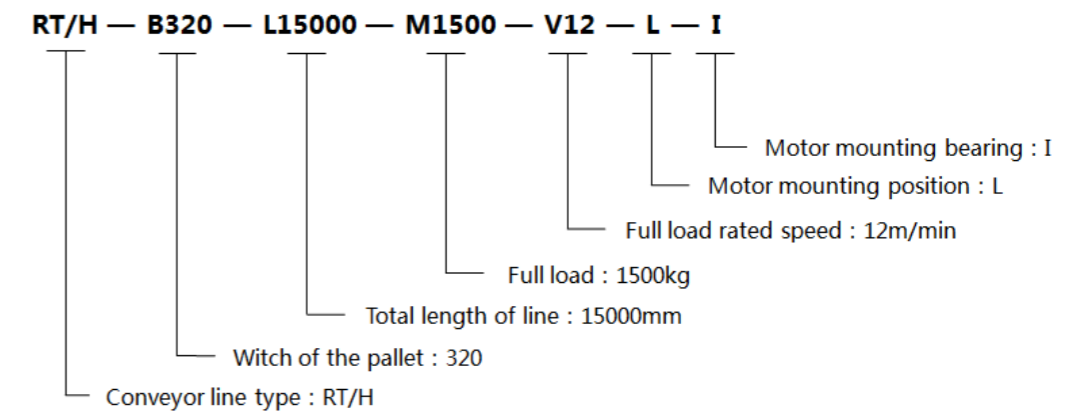

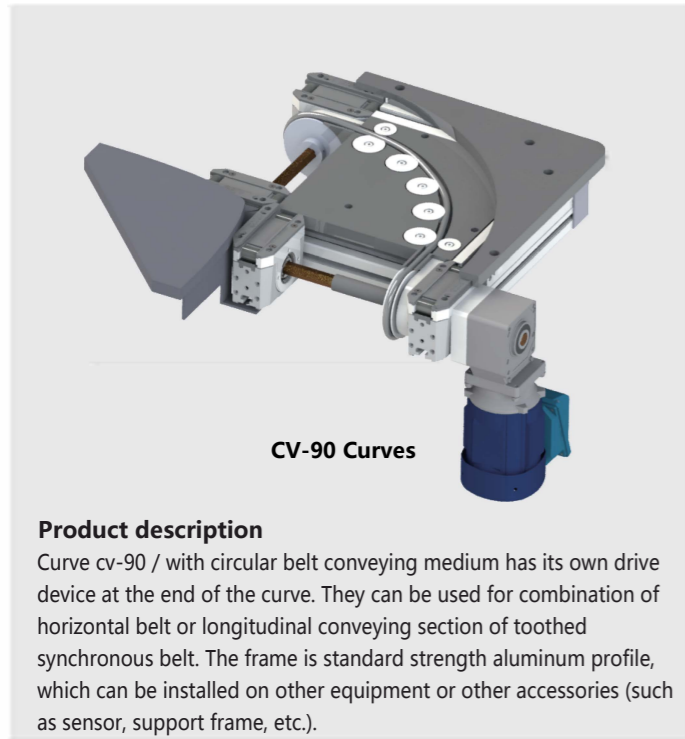

Feature

- 1 Workpiece pallet 90° bend conveyor;
- 2 Maximum total weight of workpiece pallet 20 kg;
- 3 Transmission medium: antistatic circular belt;
- 4 Suitable for grease-free and oil-free environment;
- 5 Do not change the direction of the pallet;
- 6 The motor is mounted at the end of the conveyor direction of the pallet;
- 7 It can be combined with WT /SA and WT /SE.

Scope of supply

curve, equipped with drive motor

State of supply

Partial assembly / including internal baffle and motor

Special note: heap operations are not allowed.

application specification

- 1 Full load of a single pallet ≤ 20kg;
- 2 Turning mechanism can only pass through a single tray at a time. It is forbidden to push the pallet here;
- 3 Modular design, independent parts, simple structure, convenient assembly, easy maintenance;
- 4 Do not change the direction of the pallet;
- 5 The frame is standard high-strength aluminum profile, which can be used to install the conveying section on other equipment or other accessories (such as sensors, support frames, etc.);
- 6 The motor is mounted at the end of the conveyor direction of the pallet.

Order number description

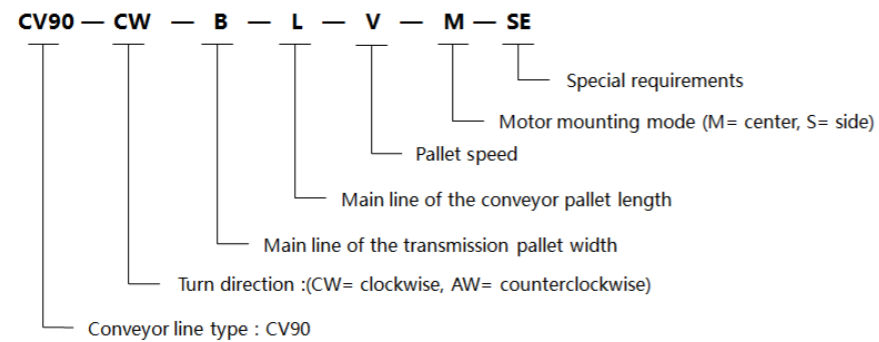

Sample order

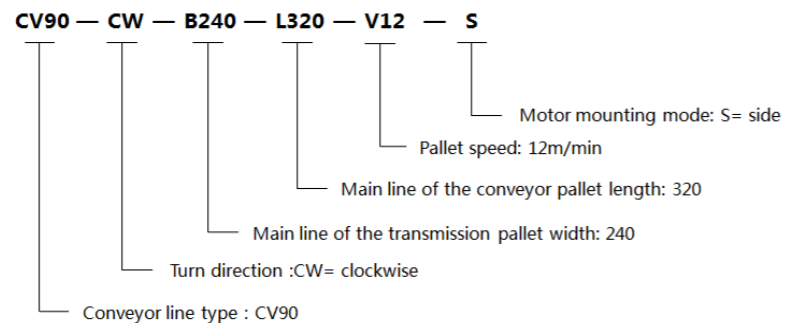

Schematic diagram

Motor installation mode S, bend direction AW

Parameter configuration

B (mm) Line width of the conveying direction	160,240,320,400
L (mm)Line length of the conveying direction	160,240,320,400
B (mm) x L(mm) compound mode	160x160、240 240x160、240、320 320x240、320、400 400x320、400
Full load rated speed VN	0,6,9,12,15,18 1) (m/min)
Voltage	220/380AC 2)
Frequency	50HZ
Motor mounting position	M=center (B≥320mm) S=size
Bend direction	CW=clockwise , AW=counterclockwise

1)a. Full load rated speed is not recommended to exceed 20m/min;
b.VN=0 , It doesn't conform to reducer motors ; c.Other full load rated speed requirements are available.
2)Other power supply voltage requirements, please inquire.

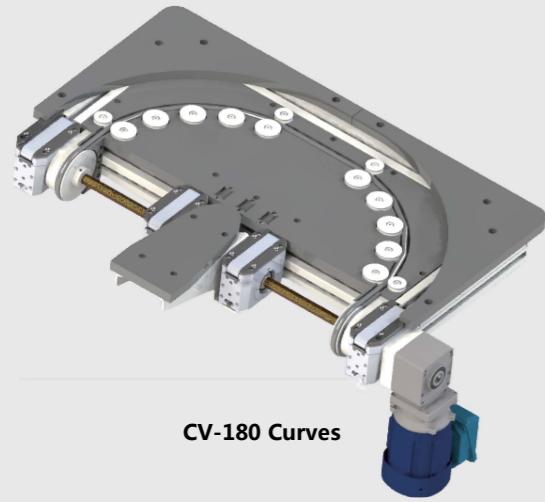

CV-180 Curves

Product description

Curve cv-90 / with circular belt conveying medium has its own drive device at the end of the curve. They can be used for combination of horizontal belt or longitudinal conveying section of toothed synchronous belt. The frame is standard strength aluminum profile, which can be installed on other equipment or other accessories (such as sensor, support frame, etc.).

Feature

- 1 Workpiece pallet 180° bend conveyor;
- 2 Maximum total weight of workpiece pallet 20 kg;
- 3 Transmission medium: antistatic circular belt;
- 4 Suitable for grease-free and oil-free environment;
- 5 Do not change the direction of the pallet;
- 6 The motor is mounted at the of the conveyor direction of the pallet;
- 7 It can be combined with TB and BC.

Scope of supply

Curve, equipped wdrive motor

State of supply

Partial assembly / including internal baffle and motor

Special note: heap operations are not allowed.

application specification

- 1 Full load of a single pallet ≤ 20kg;
- 2 Turning mechanism can only pass through a single tray at a time. It is forbidden to push the pallet here;
- 3 Modular design, independent parts, simple structure, convenient assembly, easy maintenance;
- 4 Do not change the direction of the pallet;
- 5 The frame is standard high-strength aluminum profile, which can be used to install the conveying section on other equipment or other accessories (such as sensors, support frames, etc.);
- 6 The motor is mounted at the end of the conveyor direction of the pallet.

Order number description

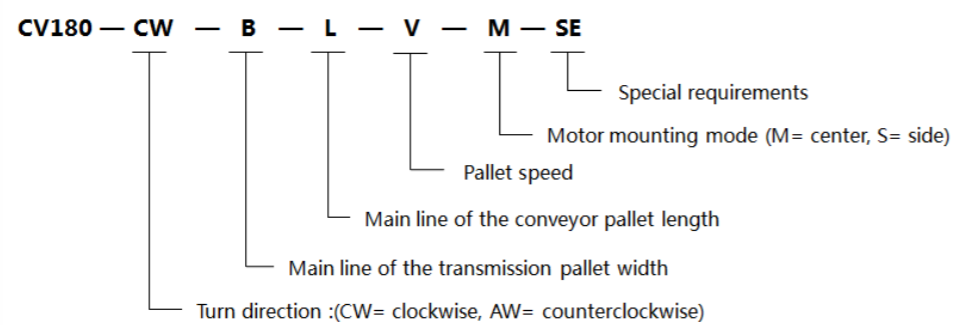

Sample order

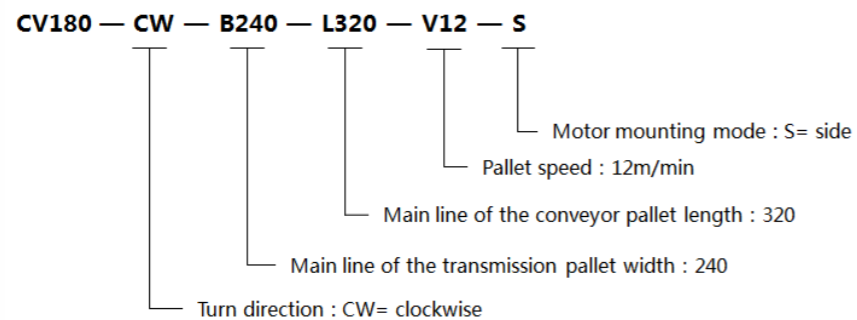

Schematic diagram

Motor installation mode S, bend direction AW

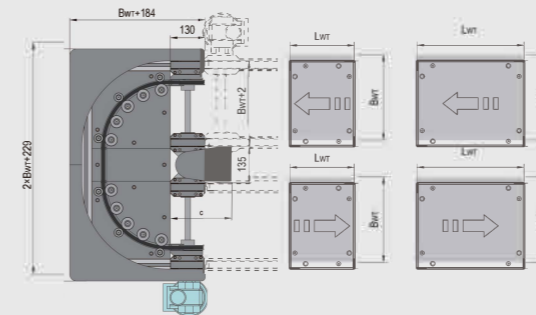

Parameter configuration

B (mm) Line width of the conveying direction	160,240,320,400
L (mm)Line length of the conveying direction	160,240,320,400
a(mm) Conveying interval	135
B (mm) x L(mm) compound mode	160x160 、 240 240x160、 240、 320 320x240、 320、 400 400x320、 400
Full load rated speed VN	0,6,9,12,15,18 1) (m/min)
Voltage	220/380AC 2)
Frequency	50HZ
Motor mounting position	M=center (B≥320mm) S=size
Bend direction	CW=clockwise , AW=counterclockwise

- 1)a. Full load rated speed is not recommended to exceed20m/min;
- b.VN=0 , It doesn't conform to reducer motors ; c.Other full load rated speed requirements are available.
- 2)Other power supply voltage requirements, please inquire.

CU Curves



CU Curves

Feature

① Can be stacked; ② Plastic chain guide; ③ Curved road, with drive device; ④ It can be combined with WT.

Accessories

Legs, mounting blocks

Scope of supply

Includes mounting material / drive motor

State of supply

Has been installed

SIZE

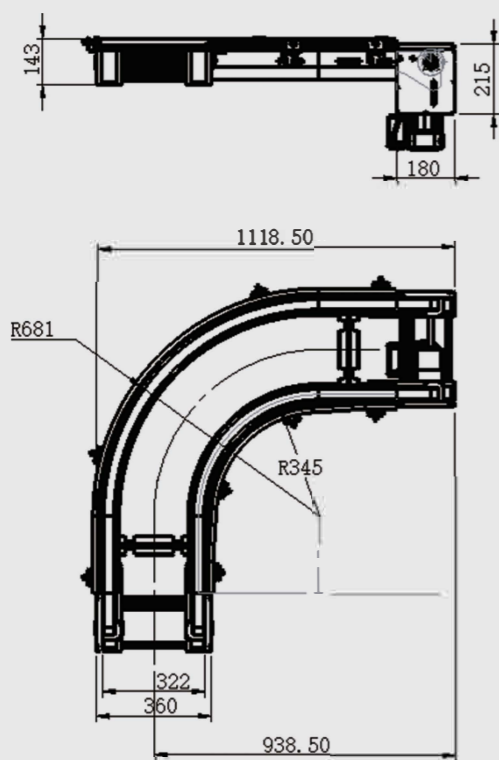

Schematic diagram

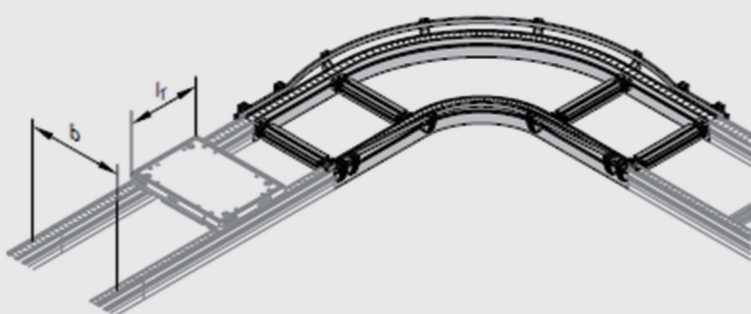

Parameter configuration

B (mm) Line width of the conveying direction	160,240,320,400,480
L (mm)Line length of the conveying direction	160,240,320,400,480
B (mm) x L(mm) compound mode	160x160、240、320
	240x160、240、320、400
	320x160、240、320、400、480
	400x240、320、400、480
	480x320、400、480

CU Curves

Order number description

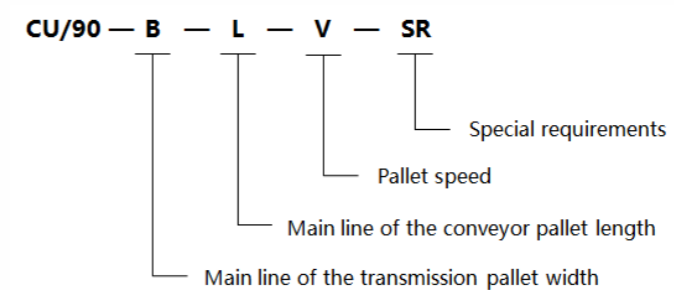

Sample order

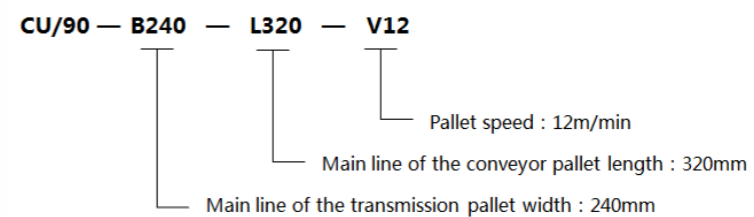

HT Lift Transverse Units

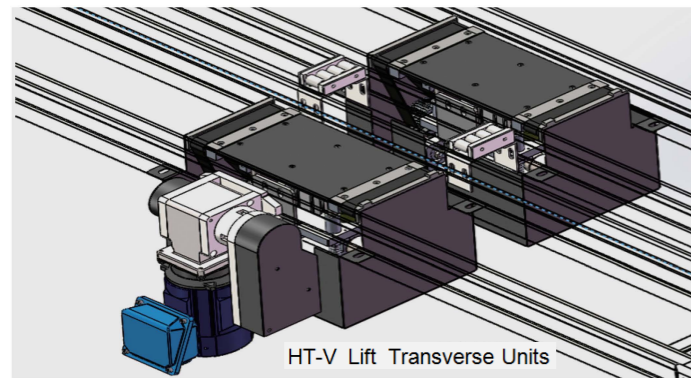

HT-V Lift Transverse Units

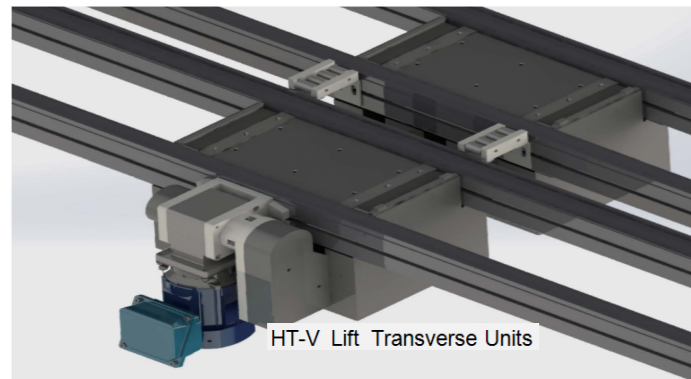

HT-V Lift Transverse Units

Product description

Move the workpiece tray from one longitudinal conveying section through one transverse belt conveying section to another parallel longitudinal conveying section which is far apart.

Features

- ① A complete set of assembly modules for connecting two small spacing parallel longitudinal conveying segments;
- ② Spacing $a = 45$... Series design of 135 mm BC conveying section;
- ③ Sprocket chain is used in series transmission;
- ④ Pneumatic equipment for 2 (upper, middle) or 3 (upper, middle, lower) lifting positions;
- ⑤ Suitable for TB/BC with profile width of 45 mm... RT/... on conveying section or profile width of 50 mm -h transport section;
- ⑥ It can be combined with WT/ E, WT and WT/F.

Accessories

Two position sensors (upper/lower), one chain buckle, one cylinder gas connection connected with a pipe 4 or 6, and one side stop plate.

Scope of supply

Includes mounting material / 2 or 3 position pneumatic device/ position induction electrical package (2x sensor)/housing/drive motor/chain buckle.

State of supply

Ht-V lifting lateral conveyor unit installed/connected components/ motor mounting kit, including drive motor/roller conveyor section with roller components/housing unassembled/chain buckles uninstalled.

Special note: you can run in the opposite direction, but stacking is not allowed

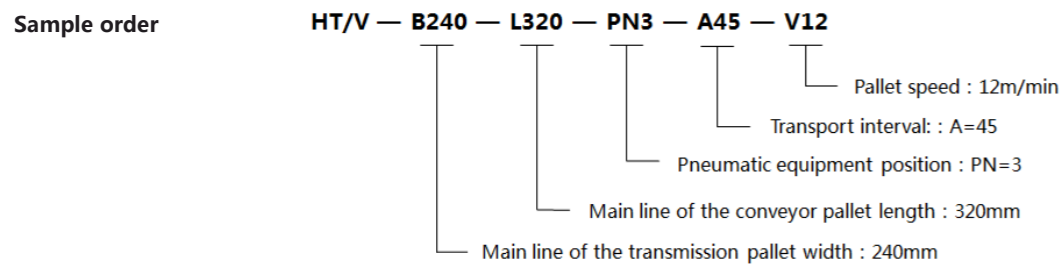
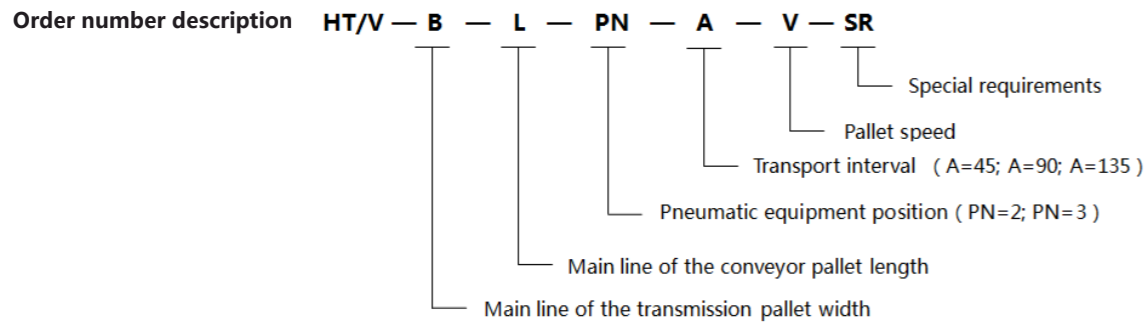

HT Lift Transverse Units

Schematic diagram

Tip: side stop plate is not available

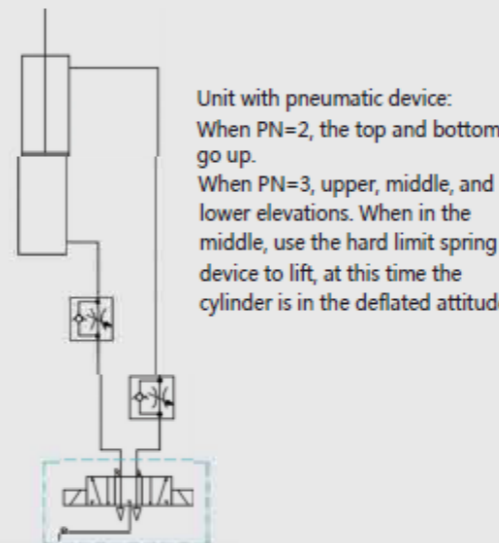
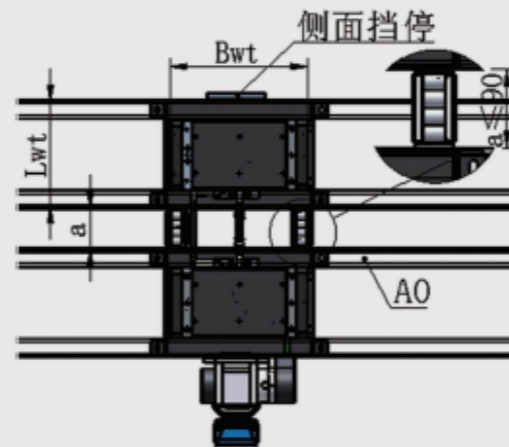

Parameter configuration

B (mm) Line width of the conveying direction	160,240,320,400
L (mm)Line length of the conveying direction	160,240,320,400
B (mm) x L (mm) compound mode	160x160、240、320
	240x160、240、320、400
	320x160、240、320、400
	400x240、320、400
Full load rated speed VN	0,6,9,12,15,18 1) (m/min)
Voltage	220/380AC 2)
Frequency	50HZ
PN Pneumatic equipment	2 3) ; 3 4)
a Conveying interval	45 ; 90 ; 135 5)

- 1)a.Full load rated speed is not recommended to exceed 20m/min; b. When VN=0, no deceleration motor is configured; c. Can be configured with other full load rated speed requirements.
- 2) Other power supply voltage requirements, please call to consult..
- 3) PN=2: upper and middle elevated positions.
- 4) PN=3: upper, middle and lower lifting positions.
- 5) a=90mm, only when bl≥240mm; A =135mm, only when bl≥320mm;

The above is applicable to the standard tray size of this mechanism. If the size of the tray has special requirements, non - standard customization, please inquire.

application specification

- ①The full load of a single pallet is less than or equal to 30KG, which can be customized for special requirements. Welcome to consult us.
- ②The horizontal conveying unit can only pass through a single pallet at a time. It is forbidden to pile up pallets here.
- ③Modular design, independent parts, simple structure, convenient assembly, easy maintenance.
- ④Transfer from the current line body to another parallel line body without changing the transport direction of the tray (single use is to change the transport direction of the tray).
- ⑤The frame is standard high-strength aluminum profile, which can be used to install the conveying section on other equipment or other accessories (such as sensors, support frames, etc.).
- ⑥Transmission medium is anti-static toothed synchronous belt.
- ⑦Can be used individually, can be used together in series, the whole motor driving medium for sprocket chain drive.
- ⑧Accept non-standard custom size, welcome to inquire.

HT Lift Transverse Units

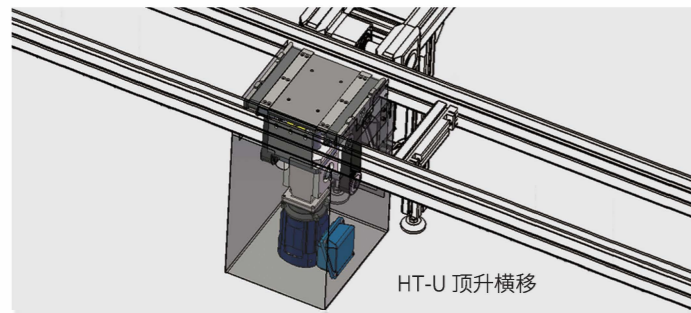

HT-U 顶升横移

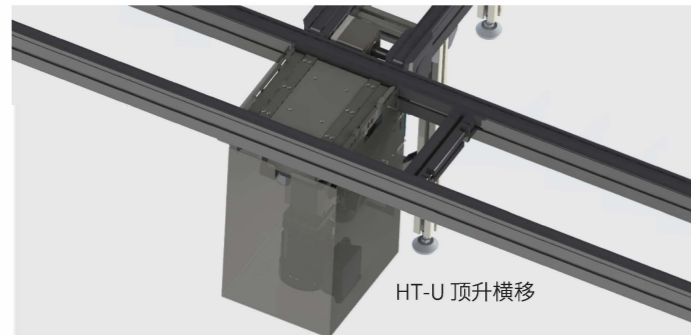

HT-U 顶升横移

Product description

Move the workpiece tray from one longitudinal conveying section through one transverse belt conveying section to another parallel longitudinal conveying section which is far apart.

Features

- ① The whole set of assembly modules are used for connecting the horizontal and vertical conveying line segments into vertical arrangement.
- ② Pneumatic equipment, for 2 (upper, middle) or 3 (upper, middle, lower) lifting position.
- ③ Suitable for installation in the profile width of 45 mm TB/BC... RT/... on conveying section or profile width of 50 mm -H transport section.
- ④ It can be combined with WT/ E, WT and WT/F.

Accessories

Two position sensors (upper/lower), one chain buckle, one cylinder gas connection connected with a pipe 4 or 6, and one side stop plate.

Scope of supply

Includes mounting material / 2 or 3 position pneumatic device/ position induction electrical package (2x sensor)/housing/drive motor/chain buckle.

State of supply

HT-U lifting lateral conveyor unit installed / connected components / housing unassembled.

Special note: reverse operation is possible, but no stacking operation is allowed. Lift the lateral conveyor unit to lift the workpiece tray from the longitudinal conveyor and transfer it horizontally to the higher lateral conveyor 10mm.

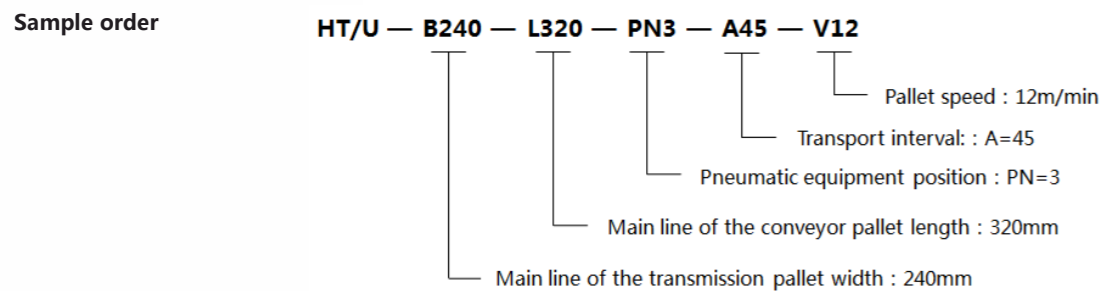
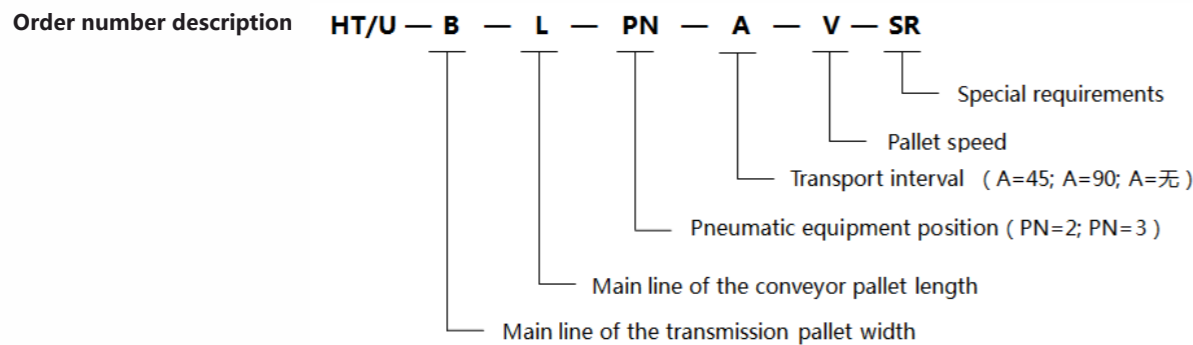

HT Lift Transverse Units

Schematic diagram

Tip: side stop plate is not available

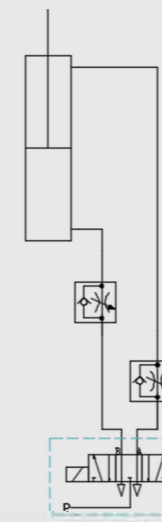
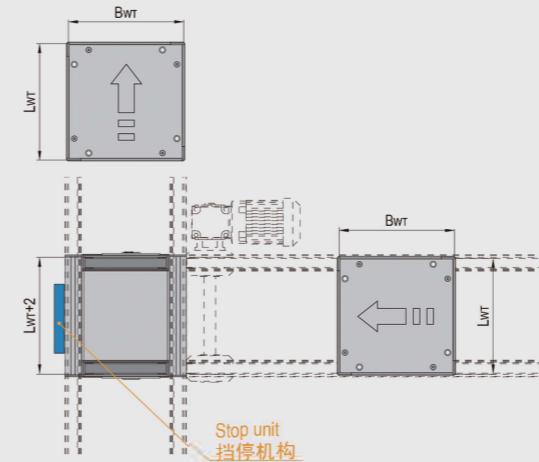

Unit with pneumatic device:
When PN=2, the top and bottom go up.
When PN=3, upper, middle, and lower elevations. When in the middle, use the hard limit spring device to lift, at this time the cylinder is in the deflated attitude.

Parameter configuration

B (mm) Line width of the conveying direction	160,240,320,400
L (mm)Line length of the conveying direction	160,240,320,400
B (mm) x L (mm) compound mode	160x160、240、320
	240x160、240、320、400
	320x160、240、320、400
	400x240、320、400
Full load rated speed VN	0,6,9,12,15,18 1) (m/min)
Voltage	220/380AC 2)
Frequency	50HZ
PN Pneumatic equipment	2 3) ; 3 4)

- 1) a.Full load rated speed is not recommended to exceed 20m/min; b. When VN=0, no deceleration motor is configured; c. Can be configured with other full load rated speed requirements.
- 2) Other power supply voltage requirements, please call to consult..
- 3) PN=2: upper and middle elevated positions.
- 4) PN=3: upper, middle and lower lifting positions.

The above is applicable to the standard tray size of this mechanism. If the size of the tray has special requirements, non - standard customization, please inquire.

Application specification

- ① The full load of a single pallet is less than or equal to 30KG, which can be customized for special requirements. Welcome to consult us.
- ② The horizontal conveying unit can only pass through a single pallet at a time. It is forbidden to pile up pallets here.
- ③ Modular design, independent parts, simple structure, convenient assembly, easy maintenance.
- ④ Transfer from the current line body to another parallel line body without changing the transport direction of the tray (single use is to change the transport direction of the tray).
- ⑤ The frame is standard high-strength aluminum profile, which can be used to install the conveying section on other equipment or other accessories (such as sensors, support frames, etc.).
- ⑥ Transmission medium is anti-static toothed synchronous belt.
- ⑦ Accept non-standard custom size, welcome to inquire.



LF/P Lift Units

Product description

Installed in both ends of TB /BC /RT conveying system, it is used for lifting double or multi-layer line bodies to realize the connection between double or multi-layer line bodies.

Features

① Complete assembly module for cylinder drive lift; ② Two positions are promoted; ③ Accuracy is generally.

accessories

Cylinder two position sensor 2, cylinder gas connector connected with six pipe, buffer stop, foot connector.

Scope of supply

Includes mounting material/position sensing electrical package (2x sensor)

State of supply

LP/P cylinder hoist unit has been installed/debugged

Application specification

- ① The full load of a single pallet is less than or equal to 30kg, which can be customized for special requirements. Welcome to consult us;
- ② The elevator can only pass through a single tray at a time. It is forbidden to push the pallet here;
- ③ Modular design, independent parts, simple structure, convenient assembly, easy maintenance;
- ④ Aluminum profile frame, standard stroke cylinder, hydraulic buffer, stroke can be fine-tuned, can realize the vertical circulation between the high and low layer conveying line, change the direction of the pallet;
- ⑤ The frame is standard high-strength aluminum profile, which facilitates the installation of other accessories (such as sensor, support frame, etc.);
- ⑥ Accept non-standard customized size, non-standard customized itinerary, welcome to inquire.

Order number description **LF/P — B — L — Ha — Hb — V — SR**

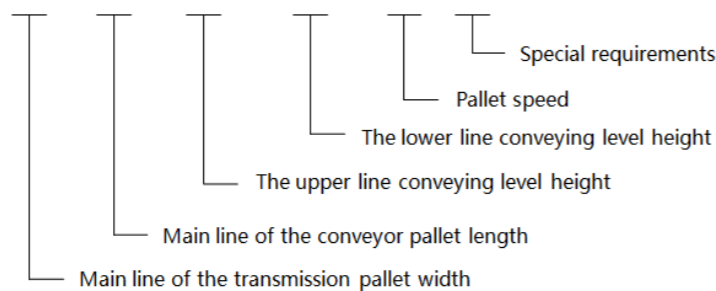

Sample order **LF/P — B240 — L320 — Ha850 — Hb400 — V12**

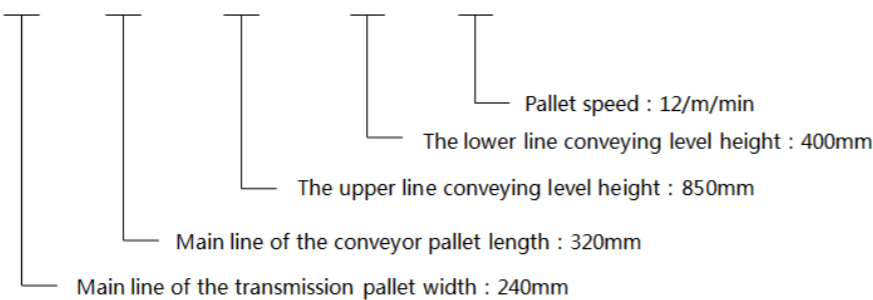

Schematic diagram

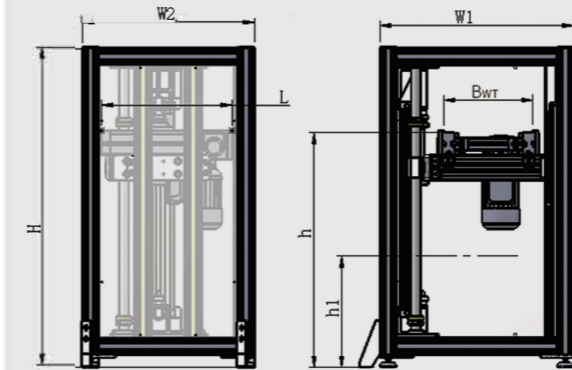

Total carrier height



Parameter configuration

B (mm) Line width of the conveying direction	160,240,320,400
L (mm) Line length of the conveying direction	160,240,320,400
B (mm) x L (mm) compound mode	160x160 、 240、 320
	240x160、 240、 320、 400
	320x160、 240、 320、 400
	400x240、 320、 400
Full load rated speed VN	0,6,9,12,15,18 1)
L	L=LWT+150
W1	W1=BWT+380
W2	W2=LWT+300
Ha	h≥h1+HWT
Hb	h1≥350
H	H≥2HWT+350

1) a.Full load rated speed is not recommended to exceed 20m/min; b. When VN=0, no deceleration motor is configured; c. Can be configured with other full load rated speed requirements.

The above is applicable to the standard tray size of this mechanism. If the size of the tray has special requirements, non - standard customization, please inquire.



LF/S Lift Units

Product description

Installed in both ends of TB /BC /RT conveying system, it is used for lifting double or multi-layer line bodies to realize the connection between double or multi-layer line bodies.

Features

- ① Complete assembly module for cylinder drive lift;
- ② Three or more promotion positions;
- ③ High precision.

accessories

Panasonic servo motor (optional), buffer stop, foot connector.

Scope of supply

Includes mounting material/position sensing electrical package (3x sensor)/Panasonic servo motor (optional)

State of supply

LP/S screw elevator unit has been installed/debugged

Application specification

- ① The full load of a single pallet is less than or equal to 30kg, which can be customized for special requirements. Welcome to consult us;
- ② The elevator can only pass through a single tray at a time. It is forbidden to push the pallet here;
- ③ Modular design, independent parts, simple structure, convenient assembly, easy maintenance;
- ④ Aluminum profile frame, standard stroke cylinder, hydraulic buffer, stroke can be fine-tuned, can realize the vertical circulation between the high and low layer conveying line, change the direction of the pallet;
- ⑤ The frame is standard high-strength aluminum profile, which facilitates the installation of other accessories (such as sensor, support frame, etc.);
- ⑥ Accept non-standard customized size, non-standard customized itinerary, welcome to inquire.

Order number description

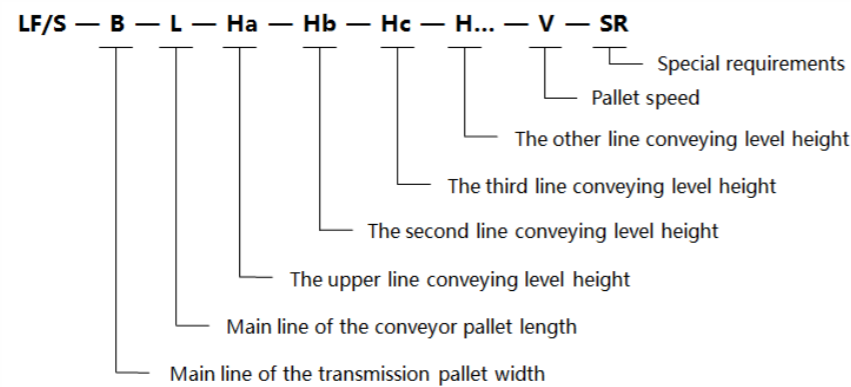

Sample order

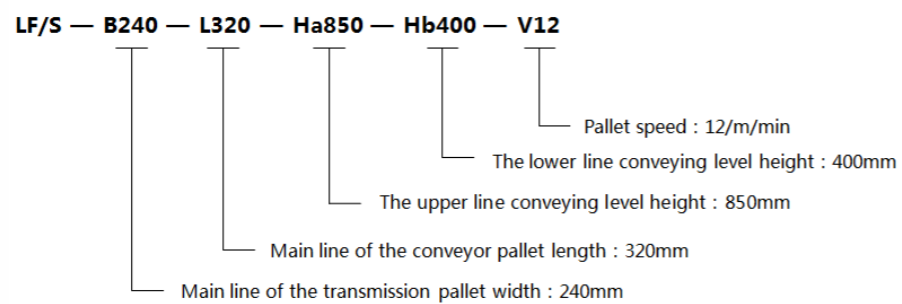

Schematic diagram

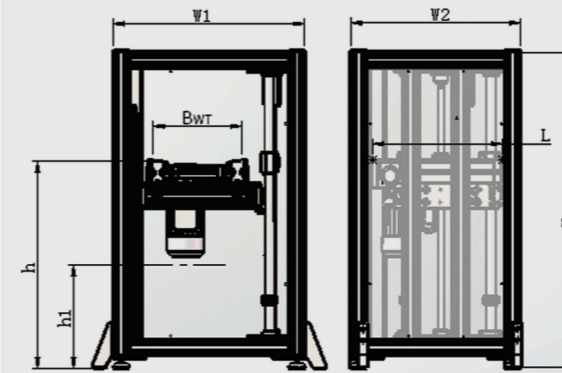

Kf kXcZXi i`Ni`^`_k



Parameter configuration

B (mm) Line width of the conveying direction	160,240,320,400
L (mm) Line length of the conveying direction	160,240,320,400
B (mm) x L (mm) compound mode	160x160、240、320
	240x160、240、320、400
	320x160、240、320、400
	400x240、320、400
Full load rated speed VN	0,6,9,12,15,18 1)
L	L=LWT+150
W1	W1=BWT+380
W2	W2=LWT+300
Ha	h≥h1+HWT
Hb	h1≥350
H	H≥2HWT+350

1) a.Full load rated speed is not recommended to exceed 20m/min; b. When VN=0, no deceleration motor is configured; c. Can be configured with other full load rated speed requirements.

The above is applicable to the standard tray size of this mechanism. If the size of the tray has special requirements, non - standard customization, please inquire.

HP Lift Positioning Units

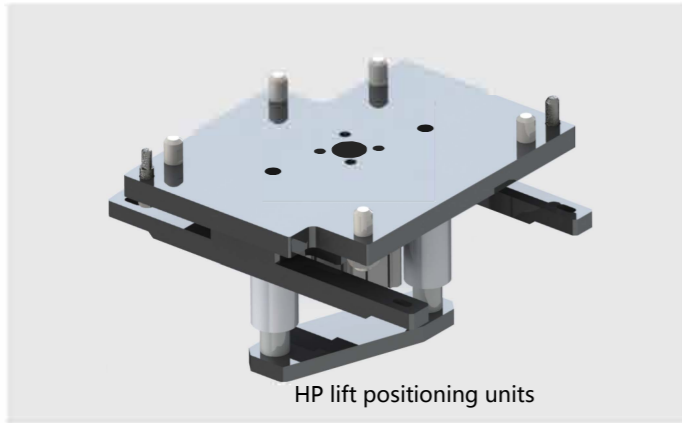

HP lift positioning units

Features

- 1 Position the pallet at manual or automatic machining station;
- 2 The positioning accuracy was ± 0.1 ;
- 3 It can be used in combination with all WT to 400x400 workpiece pallet;
- 4 The lifting positioning unit lifts the travel of WT above the conveying level by 2.5mm
- 5 The maximum total mass of the workpiece tray is ≤ 30 kg.

Accessories

Stop gate, position sensor, pneumatic quick plug connector g1/8 interface $\phi 6$.

Scope of supply

Includes mounting material/position sensing electrical package (2x sensor)

State of supply

Already assembled

Application specification

- 1 The full load of a single pallet is less than or equal to 30kg, which can be customized for special requirements, Welcome to consult us.
- 2 The jacking positioning unit can only pass through a single pallet each time. It is forbidden to push the pallet here.
- 3 Modular design, independent parts, simple structure, convenient assembly, easy maintenance.
- 4 Lifting positioning unit lifts the travel of WT above the conveying level by 2.5mm.
- 5 **Accept non-standard customized size, non-standard customized itinerary, welcome to inquire.**

Parameter configuration

B (mm) Line width of the conveying direction	160, 240, 320, 400
L (mm) Line length of the conveying direction	160, 240, 320, 400
B (mm) x L (mm) compound mode	160x160、240、320
	240x160、240、320、400
	320x160、240、320、400
	400x240、320、400

Order number description HP — B — L — M — SR

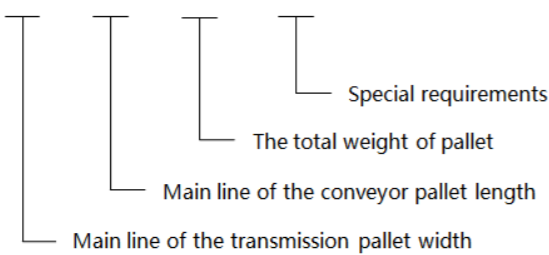

Sample order

HP — B240 — L320 — M30

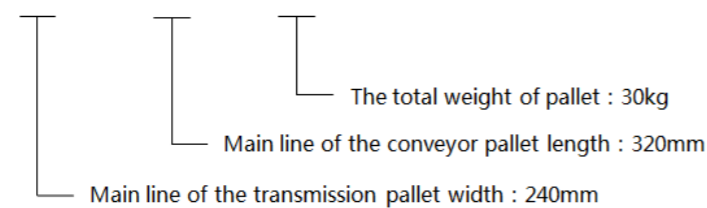

HP Lift Positioning Units

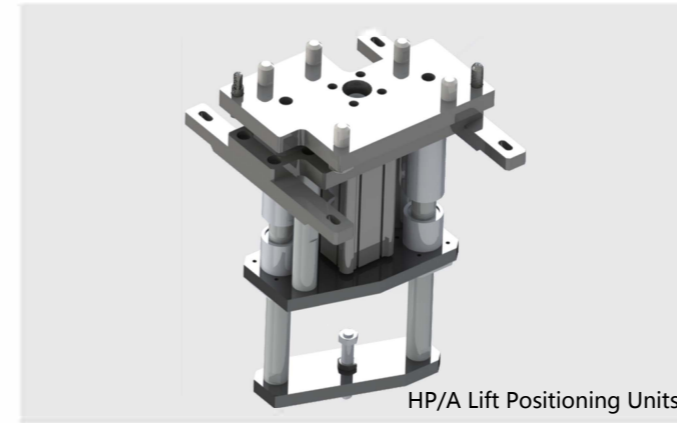

HP/A Lift Positioning Units

Features

- 1 Position the pallet on the positioning station with high precision. Position the pallet on HP/A through the positioning pin and position the sleeve on the WT workpiece pallet;
- 2 The positioning accuracy was ± 0.05 ;
- 3 It can be used in combination with all WT to 400x400 workpiece pallet;
- 4 The maximum total mass of the workpiece tray is ≤ 40 kg.

Accessories

Stop gate, position sensor, pneumatic quick plug connector $\phi 8$ mm.

Scope of supply

Includes mounting material/position sensing electrical package (2x sensor)

State of supply

Already assembled

Application specification

- 1 The full load of a single pallet is less than or equal to 40kg, which can be customized for special requirements, Welcome to consult us.
- 2 The jacking positioning unit can only pass through a single pallet each time. It is forbidden to push the pallet here.
- 3 Modular design, independent parts, simple structure, convenient assembly, easy maintenance.
- 4 Lifting positioning unit lifting WT is optional above the transport level, and it is not standard customization. Welcome to inquire.
- 5 **Accept non-standard customized size, non-standard customized itinerary, welcome to inquire.**

Parameter configuration

B (mm) Line width of the conveying direction	160, 240, 320, 400	
L (mm) Line length of the conveying direction	160, 240, 320, 400	
B (mm) x L (mm) compound mode	160x160、240、320	
	240x160、240、320、400	
	320x160、240、320、400	
	400x240、320、400	
Rated stroke H (mm)	WT in conveying horizontal plane trip H0 (mm)	
	50	0-28
	100	35-78
	150	85-128
	200	135
250	185-228	

Order number description

HP/A — B — L — M — H — SR

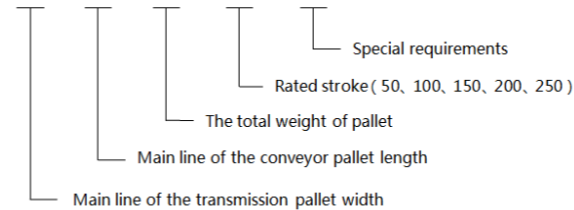

Sample order

HP/A — B240 — L320 — M40 — H50

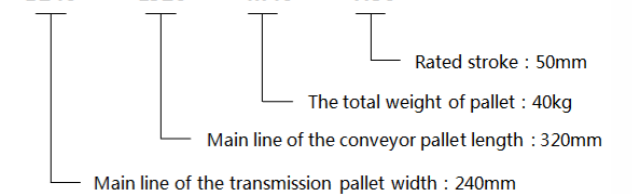

HP Lift Positioning Units

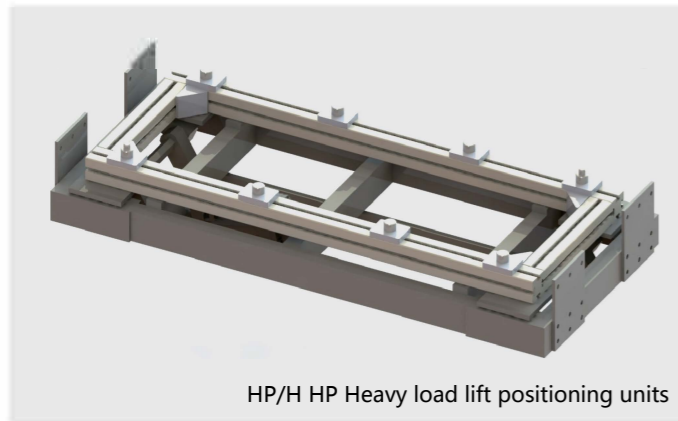

HP/H HP Heavy load lift positioning units

Features

- 1 Position the pallet at manual or automatic machining station;
- 2 Cylinder drives CAM mechanism through connecting rod to realize jacking ;
- 3 The positioning accuracy was $\pm 0.1\text{mm}$;
- 4 Can be used in combination with all WT-1200x1320 workpiece pallet;
- 5 Lifting positioning unit lifts WT 5mm above the transport level;
- 6 The maximum total mass of the workpiece tray is $\leq 30\text{kg}$;
- 7 Larger weight lift positioning unit can be customized.

Accessories

Stop gate, position sensor, pneumatic quick plug connector $\frac{1}{8}$ interface $\phi 6$.

Scope of supply

Includes mounting material/position sensing electrical package (2x sensor)

State of supply

Already assembled

Application specification

- 1 The full load of a single pallet is less than or equal to 200kg, which can be customized for special requirements, Welcome to consult us.
- 2 The jacking positioning unit can only pass through a single pallet each time. It is forbidden to push the pallet here.
- 3 Modular design, independent parts, simple structure, convenient assembly, easy maintenance.
- 4 Lifting positioning unit lifts the travel of WT above the conveying level by 5mm.
- 5 Accept non-standard customized size, non-standard customized itinerary, welcome to inquire.

Parameter configuration

B (mm) Line width of the conveying direction	720,800,...1320
L (mm) Line length of the conveying direction	320,400,...1200
B (mm) x L (mm) compound mode	720x320 、 400、 480
	800x320 、 400、 480
	...
	1320x320 、 400、 480,...

Order number description

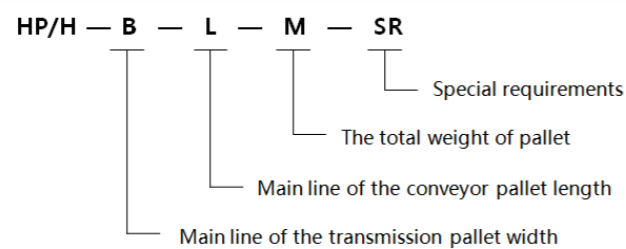

Sample order

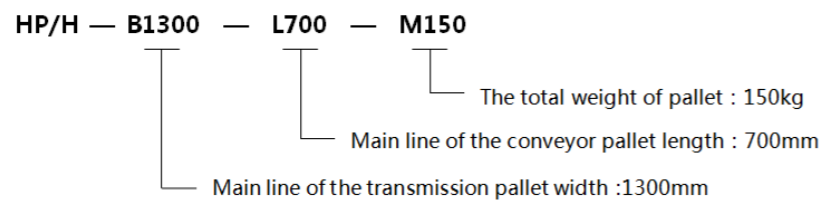

SP Stop gate

Stop gate classification

Pneumatic stop gate is an important member of the transport control system, its main role is to stop the pallet, through, separation and position induction, to achieve automatic flexible control of the pallet transport process.

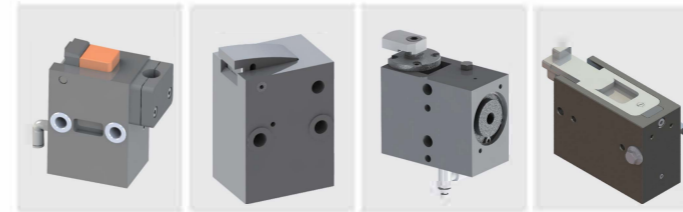

SP/N Stop gate SP/R Stop gate SP/D Stop gate SP/D-200 Stop gate

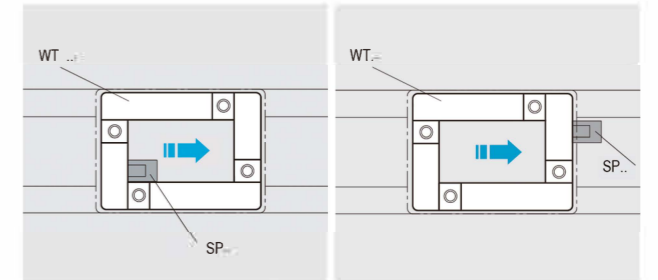

According to the occasion and different space, blocking and stopping mode can choose the inner and outer two ways

Features

- 1 Pneumatic stop gate.
- 2 Can achieve the pallet stop, through, and can achieve multiple pallet products and separation.
- 3 Do not run backwards.
- 4 Low noise; Low noise on and off;
- 5 It can be combined with WT pallet;
- 6 It also has an access switch installed on the stop-blocker to detect whether the workpiece tray has stopped or passed the stop-blocker (optional).

Accessories

Switch bracket (optional) and sweep-sensor

Scope of supply

Including installation materials/pneumatic quick plug connector $\phi 6\text{mm}$.

State of supply

Already assembled

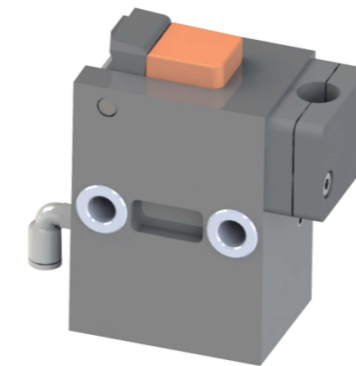

SP/N Stop gate

SIZE

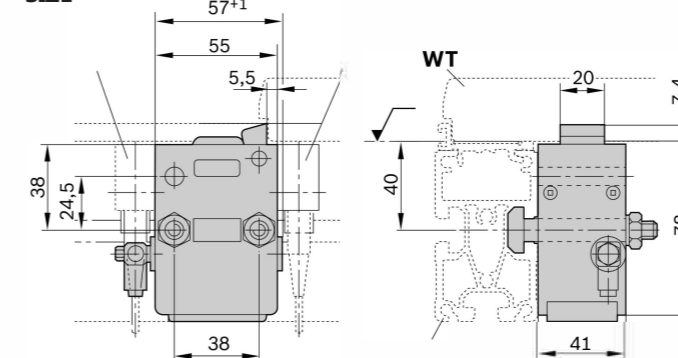

Material: main housing -- aluminum alloy (black) stop rod -- brass

kg

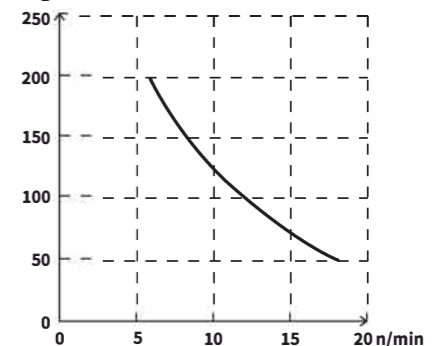

The ratio of the maximum speed of the pallet to the maximum stopping capacity of the total load

Electrical diagram

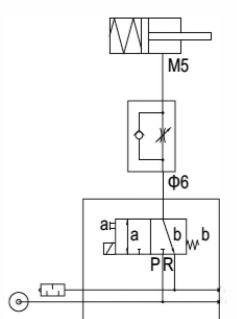

Note: solenoid valve in the figure is not within the scope of supply

Product description	Weight(g)	Order number	Delivery list
SP/N pneumatic stop gate	380	SP/N.PN.0101 (With proximity switch bracket)	T screw x2, nut x2, connection key x1, switch bracket x1
		SP/N.PN.0101 (No proximity switch bracket)	T screw x2, nut x2, connection key x1

SP Stop gate

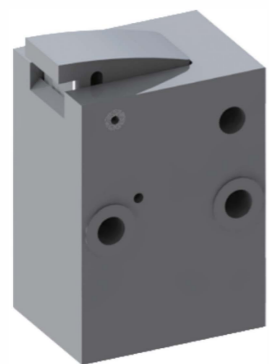

SP/R check stop

Features

- 1 The check prevents rebound from the stop stop to the workpiece tray if the transmission medium is used in combination with the roller chain without damping stop.
- 2 For the workpiece tray, the minimum total mass is 3kg and the maximum total mass is 60kg.
- 3 Under the normal state, the spring will stop the device to close, the direction of the workpiece tray through.
- 4 It can be combined with WT pallet
- 5 Running noise < 50dB

Scope of supply

Includes installation materials/pneumatic quick plug joints with parameters of $\phi 6$ mm.

State of supply

Already assembled

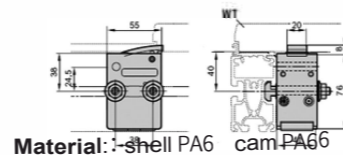

Features

- 1 Pneumatic stop stop is used for tray smooth buffer stop and separation occasions, can avoid the tray by hard stop and the rebound.
- 2 For the total weight of 60 kg workpiece tray damping effect is the best.
- 3 The adjusting screw on the back of the stop can reduce shock and adjust stepless.
- 4 It can be combined with WT pallet
- 5 Running noise < 50dB

Scope of supply

Includes installation materials/pneumatic quick plug joints with parameters of $\phi 6$ mm.

State of supply

Already assembled

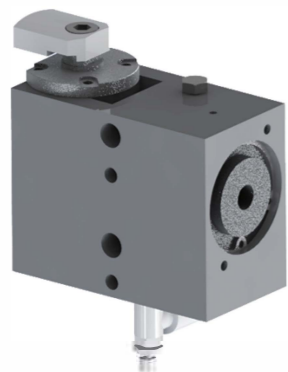

SP/D buffer stop

size

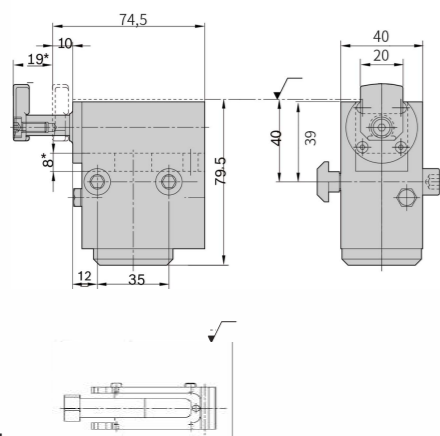

Material:
Main shell – aluminum hard oxidation (black)
Stop bar – steel. Quenching

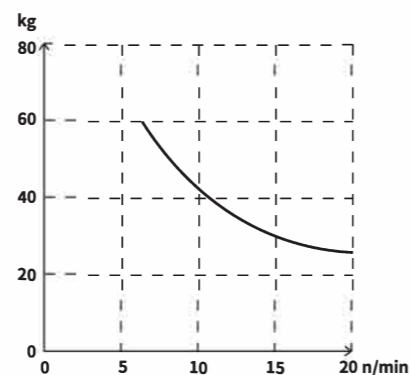

The ratio of the maximum speed of the tray to the maximum stopping capacity of the total load

Electrical diagram

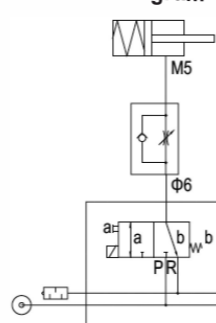

Note: solenoid valve in the figure is not within the scope of supply

Product description	Weight(g)	Order number	Delivery list
SP/R check stop gate	485	SP/R.PN.0301	T screw x2, nut x2, connection key x1
SP/D buffer stop gate	580	SP/D.PN.0201	T screw x2, nut x2, connection key x1

sp stop device

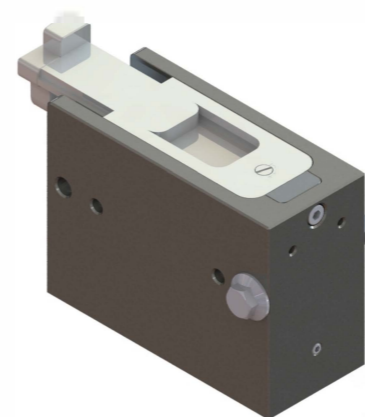

SP/D-200 buffer stop

Features

- 1 Pneumatic stop stop is used for tray smooth buffer stop and separation occasions, can avoid the tray by hard stop and the rebound.
- 2 For the total weight of 200 kg workpiece tray damping effect is the best.
- 3 The adjusting screw on the back of the stop can reduce shock and adjust stepless.
- 4 It can be combined with WT pallet;
- 5 Running noise < 50dB

Scope of supply

Includes installation materials/pneumatic quick plug joints with parameters of $\phi 6$ mm.

Delivery status

Already assembled

size

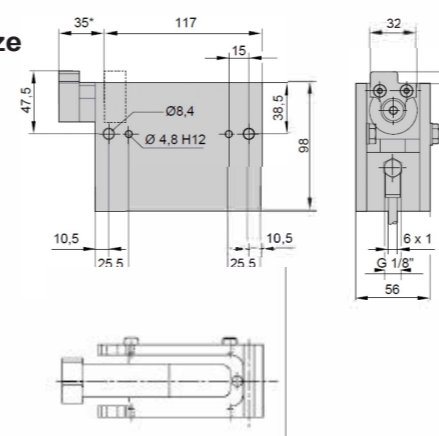

Material:
Main shell – aluminum hard oxidation (black)
Stop bar – steel. Quenching

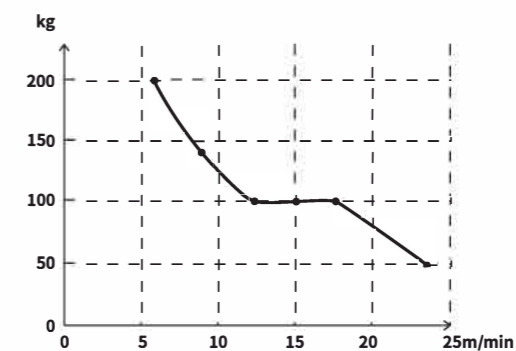

The ratio of the maximum speed of the tray to the maximum stopping capacity of the total load

Electrical diagram

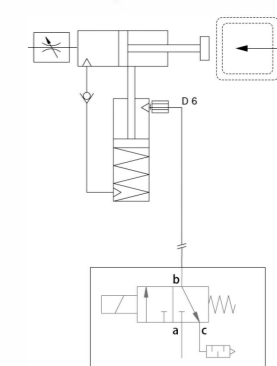

Note: solenoid valve in the figure is not within the scope of supply

Product description	Weight(g)	Order number	Delivery list
SP/D-200 check stop gate	485	SP/R.PN.0301	T screw x2, nut x2, connection key x1

Transfer line motor wiring diagram / parameter comparison table

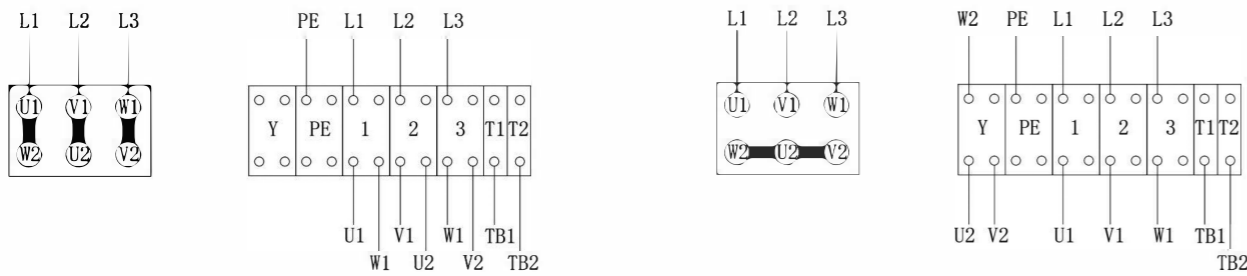

△ Type connection, power supply voltage 220AC motor junction box terminal wiring diagram

Y-type connection, wiring diagram of terminal of 380AC motor junction box

Motor wiring diagram

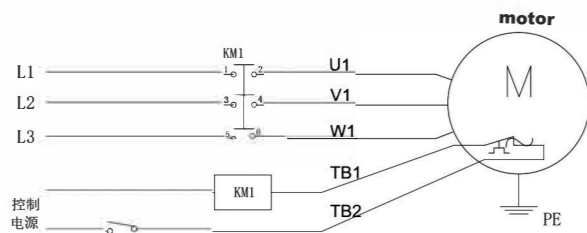

Special notes:

- A. All motors are built in with a metal hot contact connected with the overload circuit breaker, metalHot contact at 150°C±5°C, terminal TB1, TB2;
- B. The motor is suitable for continuous operation, periodic clearance operation, frequent start and stop and positive and negative rotation Run;
- C. When frequency control by frequency conversion, the power frequency of the motor after frequency conversion: motor rating Frequency ± 20% range;
- D. Power supply voltage: within the range of rated voltage ± 10%;
- E. Working environment temperature: -20°C - +40°C;
- F. Protection grade IP65;
- G. Provide motor specifications.



Conveying line motor parameter comparison table

Line type	Rated speed VN(m/min)	Heap transport allows maximum load (kg)	Frequency(HZ)	Motor power (KW)
TB TB/M	18	60	50HZ	0.2
	15	60	50HZ	0.2
	12	60	50HZ	0.2
	9	60	50HZ	0.1
	6	60	50HZ	0.1
BC	18	250	50HZ	0.4
	15	250	50HZ	0.4
	12	250	50HZ	0.4
	9	250	50HZ	0.25
	6	250	50HZ	0.25
RT	18	600	50HZ	0.55
	15	600	50HZ	0.55
	12	600	50HZ	0.55
	9	600	50HZ	0.4
	6	600	50HZ	0.4
RT/H	18	1200	50HZ	0.75
	15	1200	50HZ	0.75
	12	1200	50HZ	0.75
	9	1200	50HZ	0.55
	6	1200	50HZ	0.55